



**PARKROYAL Hotel  
Batu Ferringhi Beach  
Penang, Malaysia  
June 9-11, 2010**

Organized by



United Nations Economic and Social  
Commission for Asia and the Pacific



Asian Development Bank



Center for Global Trade Analysis

Additional Support Provided by



Asia-Pacific Research and  
Training Network on Trade



Poverty and Economic Policy  
Research Network



South Asian Network  
on Economic Modeling

*Enjoy the conference!*

## General Conference Information

### Objective

The objective of the annual conference on economic analysis is to promote the exchange of ideas among economists conducting quantitative analysis of global economic issues. Particular emphasis will be placed on applied general equilibrium methods, data, and application. Related theoretical and applied work is also welcome.

### Program Overview

The conference will commence and conclude with plenary sessions, each featuring two distinguished speakers who are intellectual leaders in their fields. Their presentations are designed to introduce participants to new topics as well as provide fresh insights into familiar ones. The content of these sessions reflect the overall conference themes:

#### Trade for Sustainable and Inclusive Growth and Development

- Renewable energy sources, environment, urbanization and trade
- Assessing options for sustainable agriculture
- Global and regional impacts of freer movements of people
- Trade, distribution and poverty
- Assessing options for efficient and sustainable trade liberalization

The conference will also feature specially organized and contributed paper sessions as well as roundtable discussion sessions. The contributed paper sessions were selected through a peer review process and grouped to reflect the varied themes being addressed by members of the GTAP Network. Papers from each session may be accessed through the conference homepage (<http://www.gtap.agecon.purdue.edu/events/conferences/2010/>) on the GTAP website.

### Conference Co-Chairs

Thomas Hertel  
Ravindra Ratnayake  
Juzhong Zhuang

### Conference Committee

Kym Anderson  
Douglas Brooks  
John Cockburn  
Bernard Decaluwe  
Stephen Karingi  
Ken Kawasaki  
Robert Koopman  
Patrick Low  
Will Martin  
Mia Mikic  
Allan Rae  
Selim Raihan  
Melanie Ramjoue  
Alexander Sarris  
Susan Stone  
Dominique van der Mensbrugge  
Terrie Walmsley

### Table of Contents

General Conference Information.....	1
PARKROYAL Hotel and Registration .....	2
Distinguished Plenary Speakers.....	3
Session Overview: Wednesday, June 9 .....	5
Session Overview: Thursday, June 10.....	6
Session Overview: Friday, June 11 .....	7
Conference Schedule: Tuesday, June 8 .....	8
Conference Schedule: Wednesday, June 9 .....	9
Conference Schedule: Thursday, June 10 .....	13
Conference Schedule: Friday, June 11 .....	23
2011 Conference Preview .....	32
Conference Participant List .....	33

*The conference co-chairs and committee welcome you  
to Penang and wish you an enjoyable  
and productive conference!*

# PARKROYAL Hotel and Registration

Upon arrival, participants must register to receive their conference materials. Dates, times and locations are listed below.

## Registration

Tuesday, June 8	15:00-17:00	Andaman Grand Ballroom
Wednesday, June 9	11:00-18:00	Andaman Grand Ballroom
Thursday, June 10	08:00-18:00	Andaman Grand Ballroom

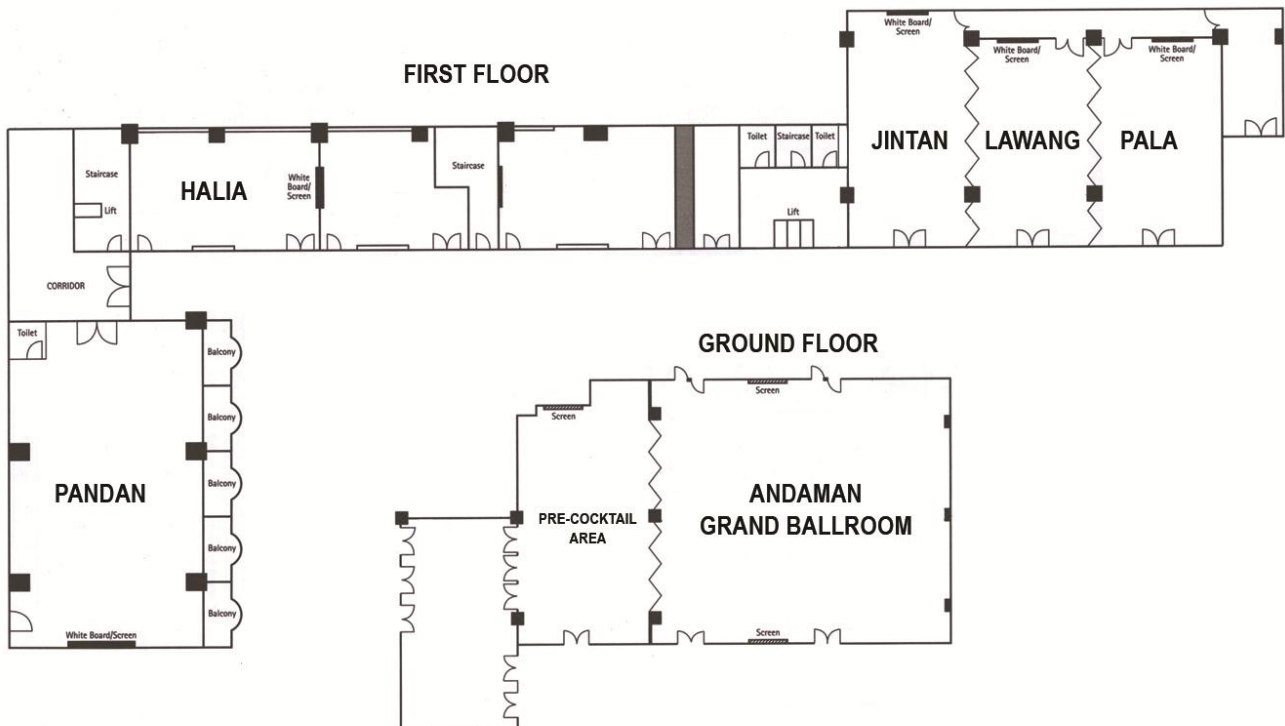

# FLOOR PLANS



## Distinguished Plenary Speakers

### “Advances in Trade Theory and Empirical Research”

Wednesday, June 9 – 14:00-15:30



#### **Masahisa Fujita**

“Spatial Economics and Global Economic Analysis”

Masahisa Fujita is the President and Chief Research Officer of Research Institute of Economy, Trade and Industry; Professor of Konan University; and Adjunct Professor of Institute of Economic Research at Kyoto University. He had previously served as Professor in the Department of Economics / Regional Science at the University of Pennsylvania; Professor of the Institute of Economic Research at Kyoto University; and President of the Institute of Developing Economies - JETRO (2003-2007). He had also served as the President of Japanese Economic Association (2009-2010). He holds a PhD in regional science from the University of Pennsylvania. His research and teaching interests are urban economics, regional economics, international trade, and spatial economics. His major works include: *The Spatial Economy: Cities, Regions, and International Trade*, MIT Press, 1999 (with P. Krugman and A.J. Venables); *Economics of Agglomeration: Cities, Industrial Location, and Regional Growth*, Cambridge University Press, 2002 (with J. Thisse); *Regional Integration in East Asia: From the Viewpoint of Spatial Economics* (editor), Macmillan, 2007.



#### **Andrew B. Bernard**

“Discovering Firms in International Trade”

Andrew B. Bernard is the Jack Byrne Professor of International Economics and Director of the Center for International Business at the Tuck School of Business at Dartmouth. He has been on the faculty at Tuck since 1999. He received his Ph.D from Stanford in economics in 1991, his A.B. from Harvard in 1985 and was on the faculty at MIT and Yale prior to coming to Tuck. Professor Bernard is an expert in international trade and investment and specializes in firm responses to globalization. His work with J. Bradford Jensen on firms, productivity and exporting provided the foundation for the new theoretical and empirical research on firms in international trade and investment. In recent papers he has explored the role of multi-product firms in production and trade, analyzed the effects of trade with low-cost countries such as China on firm strategy and performance, and begun to investigate the role of intermediaries in exports and imports. His current research is on transfer pricing by U.S. exporters and the role of multinationals in international trade and production. Professor Bernard serves as an independent director of the National Stock Exchange, on the executive committee of the Conference on Research in Income and Wealth and on the faculty advisory board of the Center for Financial Inclusion. In addition to being published in top academic journals such as the *American Economic Review* and the *Review of Economic Studies*, his research has been featured on CNN, CNBC, Good Morning America, MSNBC, NPR's Morning Edition, the Marketplace Morning Report, the BBC, and in the New York Times, Wall Street Journal, Financial Times, the Economist, Nikkei, Fortune, and Business Week.

## Distinguished Plenary Speakers

### “Climate Change”

Friday, June 11 – 16:30-18:00



#### **Dominique van der Mensbrugghe**

“The modeling of the economics of climate change: Stocktaking and future challenges”

Dominique van der Mensbrugghe is a Lead Economist in the Development Prospects Group of the World Bank. Since joining the Bank in 1999, his work has focused on long-term structural change of the global economy and the analysis of global economic policy issues—including regional and multilateral trade agreements, international migration, the Millennium Development Goals, and climate change. His work has appeared frequently in the Group’s annual flagship reports and he is one of the world’s experts on global computable general equilibrium modeling. Prior to joining the World Bank, Dominique worked for 10 years at the Organisation for Economic Co-operation and Development (OECD) based in Paris. He holds both Belgian and U.S. citizenship, received his undergraduate degree in mathematics at the Université Catholique de Louvain in Belgium and holds a PhD in economics from the University of California, Berkeley.



#### **John Quiggin**

“Intergenerational equity, risk and climate modeling”

John Quiggin is a Federation Fellow in Economics and Political Science at the University of Queensland. He is prominent both as a research economist and as a commentator on Australian economic policy. He has produced over 1000 publications, including five books and over 300 journal articles and book chapters, in fields including environmental economics, risk analysis, production economics, and the theory of economic growth. He has also written on policy topics including climate change, micro-economic reform, privatisation, employment policy and the management of the Murray-Darling river system. John Quiggin has been an active contributor to Australian public debate in a wide range of media. He is a regular columnist for the Australian Financial Review, to which he also contributes review and feature articles. He frequently comments on policy issues for radio and TV. He was one of the first Australian academics to present publications on a website (now at <http://www.uq.edu.au/economics/johnquiggin>). In 2002, he commenced publication of a blog (now at <http://johnquiggin.com>) providing daily comments on a wide range of topics.

## Session Overview: Wednesday, June 9

Full session details follow throughout the program.

Times	Session Rooms					
	Andaman Grand Ballroom	Pandan	Halia	Jintan	Lawang	Pala
13:30-14:00	Opening Remarks					
14:00-15:30	<b>Plenary Session</b> Advances in Trade Theory and Empirical Research					
16:00-18:00	<b>Session 1</b> Services and Trade Facilitation	<b>Session 2</b> Economic Integration, Trade Preferences and the Impact of the Crisis <i>(Organized Session)</i>	<b>Session 3</b> Trade and Climate Change—Issues and Implications for Research <i>(Roundtable Session)</i>	<b>Session 4</b> Global Food and Asian Agriculture	<b>Session 5</b> Water, Waste and Global Land Use	<b>Session 6</b> Sectoral FDI <i>(Organized Session)</i>

## Session Overview: Thursday, June 10

Full session details follow throughout the program.

Times	Session Rooms					
	Andaman Grand Ballroom	Pandan	Halia	Jintan	Lawang	Pala
<b>08:30-10:00</b>	<b>Session 7</b> Trade, Climate Change and Land Use	<b>Session 8</b> Revised Labor Statistics for the GTAP Data Base <i>(Organized Session)</i>	<b>Session 9</b> Trade and Poverty	<b>Session 10</b> Trade Liberalization and Poverty	<b>Session 11</b> Services Trade	<b>Session 12</b> Africa and Growth
<b>10:30-12:30</b>	<b>Session 13</b> Information, Knowledge and FDI	<b>Session 14</b> Linking PE and GE Models: The Case of Combined Application of CAPRI and GTAP for Multi-Scale Analysis of Agricultural and Environmental Policies <i>(Organized Session)</i>	<b>Session 15</b> Towards a Systematic Approach to Aid for Trade <i>(Roundtable Session)</i>	<b>Session 16</b> Carbon Pricing and Climate	<b>Session 17</b> Bioenergy	<b>Session 18</b> Trade Liberalization and Finland
<b>14:00-15:30</b>	<b>Session 19</b> Poverty and Trade	<b>Session 20</b> The Potential Implications of the Special Safeguard Mechanism <i>(Organized Session)</i>	<b>Session 21</b> Modelling Issues	<b>Session 22</b> Migration	<b>Session 23</b> Trade and Environmental Implications	<b>Session 24</b> Climate Change and Agriculture
<b>16:00-18:00</b>		<b>Session 25</b> Climate Change	<b>Session 26</b> Protection Databases <i>(Roundtable Session)</i>	<b>Session 27</b> Agricultural Trade and Free Trade Agreements	<b>Session 28</b> Agricultural Policy	<b>Session 29</b> Climate Change and Agriculture

## Session Overview: Friday, June 11

Full session details follow throughout the program.

Times	Session Rooms					
	Andaman Grand Ballroom	Pandan	Halia	Jintan	Lawang	Pala
08:30-10:30		<b>Session 30</b> Labor Issues and Poverty	<b>Session 31</b> Democratization of Trade Policy Design <i>(Roundtable Session)</i>	<b>Session 32</b> Fossil Fuels, Natural Gas and Oil Prices	<b>Session 33</b> Preferential Arrangements and the European Union	<b>Session 34</b> Taxes and Fiscal Policy
11:00-12:30		<b>Session 35</b> Data and analysis of global economic integration <i>(Organized Session)</i>	<b>Session 36</b> Asia as a locomotive of growth <i>(Roundtable Session)</i>	<b>Session 37</b> Agricultural Policies and Doha Round Negotiations	<b>Session 38</b> Financial Crisis and Free Trade Agreements	<b>Session 39</b> Free Trade Agreements
14:00-16:00	<b>Session 40</b> Trade Liberalization and Latin America	<b>Session 41</b> Global Financial and Economic Crisis: Responses from the Asian Developing Countries <i>(Organized Session)</i>	<b>Session 42</b> China and Mongolia	<b>Session 43</b> Economic Crisis and Business Cycles	<b>Session 44</b> China and India	<b>Session 45</b> European Trade Policy
16:30-18:00	<b>Plenary Session</b> Climate Change					
18:00-18:30	<b>2011 Conference Preview</b> Closing Remarks					



## Conference Schedule: Tuesday, June 8

<b>Time</b>	<b>Event</b>	<b>Location</b>
15:00-17:00	Conference Registration	Andaman Grand Ballroom

## Conference Schedule: Wednesday, June 9

Presenters should arrive 10 minutes early to their session room with their presentation on a USB drive.  
Presenters are denoted in bold.

Time	Event	Location
11:00	<b>Conference Registration</b>	<b>Andaman Grand Ballroom</b>
12:00-13:30	<b>Lunch</b>	<b>Tamarind Brasserie (PARKROYAL)</b>
13:30-14:00	<b>Opening Remarks</b> Ravindra Ratnayake, Juzhong Zhuang, Thomas Hertel	<b>Andaman Grand Ballroom</b>
14:00-15:30	<b>Plenary Session</b> <b>“Advances in Trade Theory and Empirical Research”</b> Chair: Alan Deardorff  <ul style="list-style-type: none"> <li>- <u>Spatial Economics and Global Economic Analysis</u> by <b>Fujita, Masahisa</b></li> <li>- <u>Discovering Firms in International Trade</u> by <b>Bernard, Andrew</b></li> </ul>	<b>Andaman Grand Ballroom</b>
15:30-16:00	<b>Break</b>	<b>Pre-Cocktail Area</b>
16:00-18:00	<b>Session 1</b> <b>“Services and Trade Facilitation”</b> Chair: Ken Kawasaki  <ul style="list-style-type: none"> <li>- <u>Distribution services and differential producer and consumer price impacts of trade</u> by <b>Francois, Joseph</b>, Miriam Manchin and Hanna Norberg</li> <li>- <u>Estimations of Tariff Equivalentents for the Services Sectors</u> by <b>Fontagné, Lionel</b>, Guillin Amelie and Maria Cristina Mitaritonna</li> <li>- <u>Time as a Barrier to Trade: A GTAP Database of Ad Valorem Trade Time Costs</u> by <b>Minor, Peter</b></li> <li>- <u>A Global Assessment of the Trade Facilitation Effects: the Case of MIRAGE Model</u> by <b>Zaki, Chahir</b></li> </ul>	<b>Andaman Grand Ballroom</b>

## Conference Schedule: Wednesday, June 9

Presenters should arrive 10 minutes early to their session room with their presentation on a USB drive.  
Presenters are denoted in bold.

Time	Event	Location
16:00-18:00	<p><b>Session 2 – Organized Session</b>  <b>“Economic Integration, Trade Preferences and the Impact of the Crisis”</b>  Organizer/Chair: Lucian Cernat</p> <ul style="list-style-type: none"> <li>- <u>The value of trade preferences</u> by <b>Mitaritonna, Maria Cristina</b></li> <li>- <u>The Impact of Crisis-Related Changes in Trade Flows on Employment, Incomes, Regional and Sectoral Development in Brazil</u> by McDonald, Scott, Marion Jansen, Erik von Uexkull and <b>Ralf Peters</b></li> <li>- <u>Mid-term Evaluation of the EU’s Generalised System of Preferences</u> by Gasiorek, Michael, Peter Holmes, Jim Rollo, <b>Maximiliano Méndez Parra</b>, Zhenkun Wang, Javier Lopez Gonzalez, Maryla Maliszewska, Wojciech Paczynski, Xavier Cirera, Dirk Willenbockel, Kamala Dawar, Francesca Foliano and Olarreaga Marcelo</li> <li>- <u>Economic Integration and the two margins of trade: An application to the Euro-Mediterranean agreements</u> by <b>Bensassi, Sami</b>, Laura Marquez-Ramos and Inmaculada Martinez-Zarzoso</li> </ul>	Pandan
16:00-18:00	<p><b>Session 3 – Roundtable Discussion Session</b>  <b>“Trade and Climate Change—Issues and Implications for Research”</b>  Organizer/Chair: Aziz Elbehri</p> <ul style="list-style-type: none"> <li>- Bioenergy policy work and where we stand on the cusp of the "new" demands for CC research by <b>Tyner, Wally</b></li> <li>- WTO regulations, trade and investments options in mitigating climate change in light of the different policies and initiatives by <b>Elbehri, Aziz</b></li> <li>- Specific implications for trade research and quantitative modelling issues and the types of challenges to face economists/modellers as they grapple with the trade-climate change linkages by <b>van der Mensbrugge, Dominique</b></li> </ul>	Halia

## Conference Schedule: Wednesday, June 9

Presenters should arrive 10 minutes early to their session room with their presentation on a USB drive.  
Presenters are denoted in bold.

Time	Event	Location
16:00-18:00	<b>Session 4</b> <b>“Global Food and Asian Agriculture”</b> Chair: Tasneem Mirza  - <u>The Impacts of Different Policies on Global Food Production</u> by <b>Huan-Niemi, Ellen</b> and Janne Niemi  - <u>The rise in International Food Prices: The Impact on and Policy Implications for Indonesian Food Security</u> by <b>Oktaviani, Rina</b>  - <u>Agricultural and Macroeconomic Impact of Rising Imported Grain Prices on Taiwan</u> by <b>Lin, Hsing-Chun</b> , Ching-Cheng Chang, Shih-Hsun Hsu, Duu-Hwa Lee and Li-Chen Chou  - <u>Trade and Distributional impact of Genetically Modified Crops in India: A CGE analysis</u> by <b>Chatterjee, Amrita</b> , Arpita Ghose and Sanjib Pohit	Jintan
16:00-18:00	<b>Session 5</b> <b>“Water, Waste and Global Land Use”</b> Chair: Roberto Roson  - <u>Closing the factory doors until better times: CGE modelling of drought using a theory of excess capacity</u> by <b>Wittwer, Glyn</b> and Marnie Griffith  - <u>The contribution to climate change mitigation policy of Energy from Waste in Italy</u> by Bosello, Francesco, Lorenza Campagnolo, <b>Fabio Eboli</b> and Ramiro Parrado  - <u>Water scarcity and virtual water trade in the Mediterranean</u> by <b>Sartori, Martina</b> and Roberto Roson  - <u>Implementing endogenous technological change in a global land-use model</u> by <b>Schmitz, Christoph</b> , Jan Philipp Dietrich, Hermann Lotze-Campen, Christoph Müller and Alexander Popp	Lawang

## Conference Schedule: Wednesday, June 9

Presenters should arrive 10 minutes early to their session room with their presentation on a USB drive.  
Presenters are denoted in bold.

<b>Time</b>	<b>Event</b>	<b>Location</b>
<b>16:00-18:00</b>	<b>Session 6 – Organized Session</b> <b>“Sectoral FDI”</b> Organizer/Chair: Tani Fukui  <ul style="list-style-type: none"><li>- <u>Sectoral Impact of Barriers to Trade in Banking Services: A Cost and Profit-based Approach</u> by <b>Dinh, Huong</b></li> <li>- <u>Sector Specific Foreign Direct Investment: A Database</u> by <b>Fukui, Tani</b></li> <li>- Discussant: Patrick Jomini</li></ul>	<b>Pala</b>
<b>18:30</b>	<b>Conference Reception</b> Please note that food and beverage will be served; however, alcohol will only be offered on a cash bar basis.	<b>Hotel Garden (PARKROYAL)</b>

## Conference Schedule: Thursday, June 10

Presenters should arrive 10 minutes early to their session room with their presentation on a USB drive.  
Presenters are denoted in bold.

Time	Event	Location
08:00	<b>Conference Registration</b>	<b>Andaman Grand Ballroom</b>
08:30-10:00	<b>Session 7</b> <b>“Trade, Climate Change and Land Use”</b> Chair: Hom Pant  - <u>The impact of trade openness on CO2 emissions in Iran, 1971-2005</u> by <b>Fotros, Mohammad Hassan</b> and Reza Maaboudi  - <u>The circular flow of CO2 emissions embodied in international trade</u> by <b>Marques, Alexandra</b> , Joao Rodrigues and Tiago Domingos  - <u>Effects of GHG Mitigation Policies on Livestock Sectors</u> by <b>Golub, Alla</b> , Benjamin Henderson, Thomas Hertel, Steven Rose and Misak Avetisyan	<b>Andaman Grand Ballroom</b>
08:30-10:00	<b>Session 8 – Organized Session</b> <b>“Revised Labor Statistics for the GTAP Data Base”</b> Organizer/Chair: Marinos Tsigas  - <u>Labor Statistics for the GTAP Data Base</u> by <b>Weingarden, Alison</b> and Marinos Tsigas  - <u>Trade with China and the Impact on Relative Wages in Industrial Economies</u> by <b>Mirza, Tasneem</b> , Badri Narayanan and Nico van Leeuwen  - Discussants: Nico van Leeuwen and Niven Winchester	<b>Pandan</b>
08:30-10:00	<b>Session 9</b> <b>“Trade and Poverty”</b> Chair: Syud Amer Ahmed  - <u>Laos’s World Trade Organization Accession and Poverty Reduction</u> by <b>Phouphet, Kyophilavong</b> , Takamatsu Shinya and Ko Jong-Hwan  - <u>The Economic and Poverty Impacts of Trade Liberalization in Senegal</u> by Cockburn, John, Bernard Decaluwe, Erwin Corong, Ismael Fofana and <b>Veronique Robichaud</b>  - <u>Are the Poverty Effects of Trade Policies Invisible?</u> by <b>Verma, Monika</b> , Ernesto Valenzuela and Thomas Hertel	<b>Halia</b>

## Conference Schedule: Thursday, June 10

Presenters should arrive 10 minutes early to their session room with their presentation on a USB drive.  
Presenters are denoted in bold.

Time	Event	Location
08:30-10:00	<b>Session 10</b> <b>“Trade Liberalization and Poverty”</b> Chair: Sadequl Islam  - <u>Does Trade Liberalization Make the Poor Better Off? Sub-Saharan Africa and the Doha Agricultural Trade Reform</u> by <b>Nuetah, J. Alexander</b> and Xian Xin  - <u>Would Freeing Up World Trade Reduce Poverty and Inequality? The Vexed Role of Agricultural Distortions</u> by <b>Anderson, Kym</b> , John Cockburn and Will Martin  - <u>Promoting Global Agricultural Growth and Poverty Reduction</u> by <b>Ivanic, Maros</b> and Will Martin	Jintan
08:30-10:00	<b>Session 11</b> <b>“Services Trade”</b> Chair: Angus Charteris  - <u>Liberalization of Services and its Implications on Cross-Border Agricultural Trade in Eastern Africa</u> by <b>Onyango, Christopher</b>  - <u>The measurement of barriers to services trade and its impact on Chinese services export</u> by <b>Bing, Jiang</b>  - <u>Business services: a source of comparative advantage</u> by <b>Nordas, Hildegunn</b>	Lawang
08:30-10:00	<b>Session 12</b> <b>“Africa and Growth”</b> Chair: Peter Minor  - <u>The Two-Gap Model Of Economic Growth In Nigeria: Vector Autoregression (Var) Approach</u> by <b>Akande, Emmanuel</b> and Oluyomi Sodipe  - <u>Surmounting Africas Trade Capacity Constraints: An Assessment of the Effectiveness of Aid for Trade</u> by <b>Karingi, Stephen</b>	Pala

## Conference Schedule: Thursday, June 10

Presenters should arrive 10 minutes early to their session room with their presentation on a USB drive.  
Presenters are denoted in bold.

Time	Event	Location
10:00-10:30	Break	Pre-Cocktail Area
10:30-12:30	<p><b>Session 13</b>  <b>“Information, Knowledge and FDI”</b>            Chair: David Vanzetti</p> <ul style="list-style-type: none"> <li>- <u>ICT within CGE for European Union Economies</u> by <b>Szewczyk, Wojtek</b></li> <li>- <u>Knowledge Capital, Product Differentiation and Market Structure: a Comparative Static CGE Analysis</u> by <b>Lakatos, Csilla</b></li> <li>- <u>Economic Impact of Japan's Food and Agricultural FDI on Worldwide Recipient Countries</u> by Rossi, Paula and <b>Masaru Kagatsume</b></li> <li>- <u>Multinationals in the Motor vehicles industry: A general equilibrium analysis for a Transition Economy</u> by <b>Latorre, Maria C</b> and Antonio Gomez Gomez-Plana</li> </ul>	Andaman Grand Ballroom
10:30-12:30	<p><b>Session 14 – Organized Session</b>  <b>“Linking PE and GE Models: The Case of Combined Application of CAPRI and GTAP for Multi-Scale Analysis of Agricultural and Environmental Policies”</b>            Organizer/Chair: Wolfgang Britz</p> <ul style="list-style-type: none"> <li>- <u>The CAPRI model - an overview with a focus on comparison to GTAP</u> by <b>Britz, Wolfgang</b> and Roman Keeney</li> <li>- <u>Conceptual Challenges for the Integration of Agricultural Sector and General Equilibrium Models: the databases of CAPRI and GTAP</u> by <b>Mueller, Marc</b></li> <li>- <u>How Green are Agricultural Set Asides? An Analysis at the Global and Regional Levels</u> by Britz, Wolfgang, Thomas Hertel and <b>Janine Pelikan</b></li> <li>- Discussant: Frank van Tongeren</li> </ul>	Pandan



## Conference Schedule: Thursday, June 10

Presenters should arrive 10 minutes early to their session room with their presentation on a USB drive.  
Presenters are denoted in bold.

Time	Event	Location
10:30-12:30	<p><b>Session 15 – Roundtable Discussion Session</b>  <b>“Towards a Systematic Approach to Aid for Trade”</b>  Organizer: UN Economic and Social Commission for Asia and the Pacific  Chair: Ravindra Ratnayake</p> <ul style="list-style-type: none"> <li>- <u>Towards a Systemic Approach to Aid for Trade: African Perspectives</u> by <b>Karingi, Stephen</b></li> <li>- <u>Aid for Trade in Latin America: Challenges to develop a Regional agenda</u> by <b>Durán Lima, José Elías</b></li> <li>- <u>Implementation of the EU Aid for Trade Strategy</u> by <b>Koke, Andra</b></li> <li>- Aid for Trade: A View from the WTO by <b>Low, Patrick</b></li> <li>- <u>Aid for Trade in Asia and the Pacific: ADB's Perspective</u> by <b>Zhuang, Juzhong</b></li> <li>- <u>Aid for Trade in Asia and the Pacific</u> by <b>Mikic, Mia</b></li> </ul>	Halia
10:30-12:30	<p><b>Session 16</b>  <b>“Carbon Pricing and Climate”</b>  Chair: Sergey Paltsev</p> <ul style="list-style-type: none"> <li>- <u>Will border carbon adjustments work?</u> by <b>Winchester, Niven</b>, Sergey Paltsev and John Reilly</li> <li>- <u>Is There a Care for Carbon-based Border Tax Adjustment?</u> by <b>Chateau, Jean</b>, Romain Duval and Jean-Marc Burniaux</li> <li>- <u>The Impact on U.S. industries of Carbon Prices with Output Based Rebates</u> by Adkins, Liwayway, <b>Richard Garbaccio</b>, Mun Ho, Eric Moore and Richard Morgenstern</li> <li>- <u>The Effect of Climate’s Volatility on Tourist Arrivals of Asia Countries to Taiwan</u> by <b>Chu, Lan-Fen</b></li> </ul>	Jintan

## Conference Schedule: Thursday, June 10

Presenters should arrive 10 minutes early to their session room with their presentation on a USB drive.  
Presenters are denoted in bold.

Time	Event	Location
10:30-12:30	<b>Session 17</b> <b>“Bioenergy”</b> Chair: Martina Brockmeier  <ul style="list-style-type: none"> <li>- <u>The effects of the EC ethanol blend mandate on the EU/Global sugar Market and its implications on sugar trade with ACP countries</u> by <b>Sukati, Mphumuzi</b></li> <li>- <u>Renewable Energy Development in Thailand: A Computable General Equilibrium Model-Based Analysis</u> by <b>Wianwivat, Suthin</b> and John Asafu-Adjaye</li> <li>- <u>Economic and Environmental Consequences of US Corn Ethanol Production: A Comprehensive Analysis</u> by Taheripour, Farzad, <b>Wally Tyner</b>, Thomas Hertel, Alla Golub, Dileep Birur, Uris Baldos and Qianlai Zhuang</li> <li>- <u>Addressing Indirect Land Use Change Effects of Biofuel Mandates: Insights from and Limits of the CGE Approach</u> by Alriffai, Perrihan, <b>Betina Dimaranan</b>, David Laborde and Hugo Valin</li> </ul>	Lawang
10:30-12:30	<b>Session 18</b> <b>“Trade Liberalization and Finland”</b> Chair: Antoine Bouët  <ul style="list-style-type: none"> <li>- <u>The Costs and Benefits of Duty-Free, Quota-Free Market Access for Poor Countries: Who and What Matters</u> by Bouët, Antoine, David Laborde, <b>Elisa Dienesch</b> and Kimberly Elliott</li> <li>- <u>Import Prices, Importer Income, and Importer Income Inequality: Comparing Competing Theories</u> by <b>Bekkers, Eddy</b>, Joseph Francois and Miriam Manchin</li> <li>- <u>Distributional effects of Finland’s climate policy package – Calculations with the new income distribution module of the VATTAGE model</u> by <b>Kinnunen, Jouko</b>, Juha Honkatukia and Kimmo Marttila</li> </ul>	Pala
12:30-14:00	<b>Lunch</b>	<b>Tamarind Brasserie (PARKROYAL)</b>

## Conference Schedule: Thursday, June 10

Presenters should arrive 10 minutes early to their session room with their presentation on a USB drive.  
Presenters are denoted in bold.

Time	Event	Location
14:00-15:30	<b>Session 19</b> <b>“Poverty and Trade”</b> Chair: Kym Anderson <ul style="list-style-type: none"> <li>- <u>A poverty module of the MIRAGE model of the world economy</u> by <b>Bouët, Antoine</b>, David Laborde and Carmen Estrades</li> <li>- <u>Income Distribution and Regional Trade Liberalization in South Asia</u> by <b>Gilbert, John</b> and Reza Oladi</li> <li>- <u>IMF Macroeconomic Impacts and Development Outcomes for Low Income Countries: First Exploration of Macroeconomic Links to Ethiopia and Ghana Distribution and Poverty Models</u> by <b>Evans, H. David</b></li> </ul>	<b>Andaman Grand Ballroom</b>
14:00-15:30	<b>Session 20 – Organized Session</b> <b>“The Potential Implications of the Special Safeguard Mechanism”</b> Organizer/Chair: Amanda Leister <ul style="list-style-type: none"> <li>- <u>Potential Implications of the Special Safeguard Mechanism (SSM) in Agriculture</u> by Hertel, Thomas, <b>Will Martin</b> and Amanda Leister</li> <li>- <u>Frequency and Duration Analysis of the Special Safeguard Mechanism</u> by <b>Leister, Amanda</b> and Thomas Hertel</li> </ul>	<b>Pandan</b>
14:00-15:30	<b>Session 21</b> <b>“Modelling Issues”</b> Chair: Glyn Wittwer <ul style="list-style-type: none"> <li>- <u>Does structure matter? Exploring the impact of model structure on model results</u> by <b>Kuiper, Marijke</b> and Andrzej Tabeau</li> <li>- <u>Running faster GTAP simulations with GEMPACK</u> by <b>Jerie, Michael</b></li> <li>- <u>Solving Inequality Constrained Problems using GEMPACK</u> by <b>Cao, Liangyue</b></li> </ul>	<b>Halia</b>

## Conference Schedule: Thursday, June 10

Presenters should arrive 10 minutes early to their session room with their presentation on a USB drive.  
Presenters are denoted in bold.

Time	Event	Location
14:00-15:30	<b>Session 22</b> <b>“Migration”</b> Chair: Terrie Walmsley  - <u>Measuring the Impact of International Migration and remittances: Will Latin America be a big winner?</u> by <b>Watanuki, Masakazu</b> and Julio Guzman  - <u>A Dynamic General Equilibrium Model of International Migration</u> by <b>Aguiar, Angel H.</b> and Terrie Walmsley  - <u>Economic Impacts of Immigration: Scenarios Using a Computable General Equilibrium Model of the New Zealand Economy</u> by <b>Nana, Ganesh</b> , Kel Sanderson and Rob Hodgson	Jintan
14:00-15:30	<b>Session 23</b> <b>“Trade and Environmental Implications”</b> Chair: David Roland-Holst  - <u>Environmental and Employment impact of resource use in India: A case study of copper</u> by Bhattacharjya, Souvik, <b>Saswata Chaudhury</b> , Anandajit Goswami and Sanjib Pohit  - <u>Computing game-theoretic equilibria in GTAP: Optimising regional climate change policies</u> by <b>Wiskich, Tony</b>  - <u>Reconciling Control of Carbon and Air Pollution with Economic Growth in China</u> by <b>Cao, Jing</b> , Mun Ho, Dale Jorgenson, Yu Lei, Michael McElroy, Chris Nielsen, Yuxuan Wang and Yu Zhao	Lawang
14:00-15:30	<b>Session 24</b> <b>“Climate Change and Agriculture”</b> Chair: Utpal Vasavada  - <u>Climate Change and Economic Growth: Impacts and Interactions</u> by <b>Roson, Roberto</b> and Dominique van der Mensbrugge  - <u>Climate Change Impacts on Agriculture and Internal Migration in Brazil</u> by <b>Ferreira-Filho, Joaquim Bento</b> and Mark Horridge  - <u>Climate Volatility and Trade Policy in Tanzania</u> by <b>Ahmed, Syud Amer</b> , Thomas Hertel and Will Martin	Pala

## Conference Schedule: Thursday, June 10

Presenters should arrive 10 minutes early to their session room with their presentation on a USB drive.  
Presenters are denoted in bold.

Time	Event	Location
15:30-16:00	<b>Break</b>	<b>Pre-Cocktail Area</b>
16:00-18:00	<p><b>Session 25</b>  <b>“Climate Change”</b>            Chair: Fabio Eboli</p> <ul style="list-style-type: none"> <li>- <u>Energy and Economy in 2050: Long-term macroeconomic implications of green house gas emissions - Results from combined simulations with Dynamic GTAP and TIMES Integrated Assessment Models</u> by <b>Niemi, Janne</b>, Tiina Koljonen and Antti Lehtila</li> <li>- <u>Assessing the Market Benefits of Reducing Deforestation: A General Equilibrium Investigation</u> by <b>Bosello, Francesco</b>, Ramiro Parrado and Renato Rosa</li> <li>- <u>REDD in the Carbon Market: A general equilibrium analysis</u> by Bosello, Francesco, Fabio Eboli, Ramiro Parrado and <b>Renato Rosa</b></li> <li>- <u>Modelling Sustainability in a Computable General Equilibrium Framework</u> by Carraro, Carlo, Elisa Lanzi and <b>Ramiro Parrado</b></li> </ul>	<b>Pandan</b>
16:00-18:00	<p><b>Session 26 – Roundtable Discussion Session</b>  <b>“Protection Databases”</b>            Organizer/Chair: Will Martin</p> <ul style="list-style-type: none"> <li>- Impact of Ad-Valorem Equivalent Estimation Methods in the Context of Trade Policy Analysis by <b>Mimouni, Mondher</b></li> <li>- Analytical Database for Economists on Protection and Trade by <b>Laborde, David</b></li> <li>- Alternative Agricultural Price Distortions for CGE Analysis of Developing Countries by <b>Anderson, Kym</b></li> <li>- Measuring costs and benefits of non-tariff measures in agri-food by <b>van Tongeren, Frank</b></li> </ul>	<b>Halia</b>

## Conference Schedule: Thursday, June 10

Presenters should arrive 10 minutes early to their session room with their presentation on a USB drive.  
Presenters are denoted in bold.

Time	Event	Location
16:00-18:00	<b>Session 27</b> <b>“Agricultural Trade and Free Trade Agreements”</b> Chair: Wojtek Szewczyk <ul style="list-style-type: none"> <li>- <u>Evaluation of non-tariff measures for African agricultural exports to the EU in a CGE framework</u> by <b>Gonzalez-Mellado, Aida</b>, Stephan Hubertus Gay, Robert M'Barek and Emanuele Ferrari</li> <li>- <u>Economic sanctions and trade diversions in Sudan</u> by <b>Siddig, Khalid</b></li> <li>- <u>The Economic Effects of Trans-Atlantic Free Trade Agreements</u> by <b>Islam, Sadequl</b></li> <li>- <u>The Analysis of Trade Integration and Business Cycles Synchronization with Emphasis on Regional Arrangements among OIC Nations</u> by <b>Karimi, Farzad</b> and Akbar Tavakoli</li> </ul>	Jintan
16:00-18:00	<b>Session 28</b> <b>“Agricultural Policy”</b> Chair: Amanda Leister <ul style="list-style-type: none"> <li>- <u>Estimating the Impacts of Agricultural Export Restrictions in the Global Rice Market</u> by <b>Chen, Yi-Chieh</b> and Ching-Cheng Chang</li> <li>- <u>The economic and social consequences of agricultural export taxes: A CGE – analysis for Argentina</u> by <b>Grundke, Robert</b> and Federico Foders</li> <li>- <u>Economic Impact and Global Trade Implications of Phytosanitary Treatments for Wood Packaging Material</u> by <b>Strutt, Anna</b>, James A. Turner, Lynn Garrett, Robert Haack and Lars Olson</li> <li>- <u>The revival of interest in self-sufficiency in Indonesia and its likely consequences</u> by <b>Vanzetti, David</b>, Nur Rakhman Setyoko, Ray Trewin and Risti Penami</li> </ul>	Lawang

## Conference Schedule: Thursday, June 10

Presenters should arrive 10 minutes early to their session room with their presentation on a USB drive.  
Presenters are denoted in bold.

Time	Event	Location
16:00-18:00	<p><b>Session 29</b>  <b>“Climate Change and Agriculture”</b>                      Chair: Alla Golub</p> <ul style="list-style-type: none"> <li>- <u>A Global General Equilibrium Analysis of the Interactions between Biofuel Mandates and Greenhouse Gas Mitigation Policy</u> by Beckman, Jayson, Carol Jones, Ronald Sands and <b>Utpal Vasavada</b></li> <li>- <u>Would Carbon Pricing Reduce Deforestation? Insights from illustrative simulations of a dynamic global CGE model augmented with a land use change and forestry module</u> by <b>Pant, Hom</b></li> <li>- <u>Climate Change and European Agriculture in 2050: Outlook for Cereal and Oilseed Markets</u> by <b>Moeller, Thordis</b> and Harald Grethe</li> <li>- <u>Climate Change Impacts on Global Agriculture</u> by <b>Calzadilla, Alvaro</b>, Katrin Rehdanz, Richard Betts, Pete Falloon, Andy Wiltshire and Richard Tol</li> </ul>	Pala
19:00	<p><b>Conference Dinner</b>                      Please note that alcohol will only be offered on a cash bar basis.</p>	<b>Andaman Grand Ballroom</b>

## Conference Schedule: Friday, June 11

Presenters should arrive 10 minutes early to their session room with their presentation on a USB drive.  
Presenters are denoted in bold.

Time	Event	Location
08:30-10:30	<p><b>Session 30</b>  <b>“Labor Issues and Poverty”</b>                      Chair: Niven Winchester</p> <ul style="list-style-type: none"> <li>- <u>Rural Transformation, Structural Breaks and Total Factor Productivity Growth in China</u> by <b>You, Ke Fei</b> and Nicholas Sarantis</li> <li>- <u>Natural and Social Capital in Labor Subsistent Households in Natural Resource Based Economies</u> by <b>Navarro, Gladys</b></li> <li>- <u>Sectoral Employment Growth and Technological Leadership: A Spatial Econometric Analysis for U.S. Counties</u> by <b>Pede, Valerien</b>, Raymond Florax and Henri de Groot</li> <li>- <u>The impact of the international financial crisis on child poverty in South Africa</u> by Chitiga, Margaret, Bernard Decaluwe, Ramos Mabugu, <b>Helene Maisonnave</b>, Veronique Robichaud, Debra Shepperd, Servaas Van der Berg and Dieter Von Fintel</li> </ul>	Pandan
08:30-10:30	<p><b>Session 31 – Roundtable Discussion Session</b>  <b>“Democratization of Trade Policy Design”</b>                      Organizer: Asia-Pacific Research and Training Network on Trade                      Chair: Evan Due</p> <ul style="list-style-type: none"> <li>- <u>Who Makes the Rules of Trade Policy and Trade Negotiations?</u> by <b>Deardorff, Alan</b></li> <li>- <u>Net Campaign Contributions, Agricultural Interests, and Votes on Liberalizing Trade with China</u> by <b>Tower, Edward</b> and <b>John Gilbert</b></li> <li>- <u>Distortions to markets for farm vs nonfarm goods since the 1950s: what needs explaining?</u> by <b>Anderson, Kym</b></li> <li>- <u>Trade in Asia and the Pacific: Why do governance and institutions matter?</u> by <b>De, Prabir</b></li> <li>- <u>Political economy of trade policy and negotiations in Philippines</u> by <b>Pasadilla, Gloria</b></li> <li>- <u>Towards a better understanding of the political economy of regional integration in the GMS: Stakeholder coordination and consultation for subregional trade facilitation in Thailand</u> by <b>Cheewatrakoolpong, Kornkarun</b></li> </ul>	Halia



## Conference Schedule: Friday, June 11

Presenters should arrive 10 minutes early to their session room with their presentation on a USB drive.  
Presenters are denoted in bold.

Time	Event	Location
08:30-10:30	<b>Session 32</b> <b>“Fossil Fuels, Natural Gas and Oil Prices”</b> Chair: Wally Tyner <ul style="list-style-type: none"> <li>- <u>The Role of Natural Gas under Carbon Emissions Constraint</u> by <b>Paltsev, Sergey</b>, Henry Jacoby and John Reilly</li> <li>- <u>The Effects of Energy Taxes on Energy Consumption in Finland between 1995 and 2004</u> by Honkatukia, Juha and <b>Kimmo Marttila</b></li> <li>- <u>Implications of the Oil Export Price Increase in a Two-Sector Model: Stylized and Empirical Approaches. A CGE Analysis for the Case of Kazakhstan</u> by <b>Kapsalyamova, Zhanna</b></li> <li>- <u>An Economy-wide Analysis of an Increase in Energy Prices in Russia by the Use of SMOD EN Model</u> by <b>Orlov, Anton</b>, Harald Grethe and Scott McDonald</li> </ul>	<b>Jintan</b>
08:30-10:30	<b>Session 33</b> <b>“Preferential Arrangements and the European Union”</b> Chair: Marijke Kuiper <ul style="list-style-type: none"> <li>- <u>The export potential of South African edible nuts: the special case of macadamia nuts to Germany</u> by <b>Sithole, Noleen</b></li> <li>- <u>From unilateral preferences to Reciprocity: Impact of the ACP – EU EPA on ESA countries</u> by <b>Rojid, Sawkut</b> and Vinaye Ancharaz</li> <li>- <u>Human Capital Formation and the Linkage between Trade and Poverty: The Cases of Costa Rica and Nicaragua</u> by Rivera, Luis and <b>Hugo Rojas-Romagosa</b></li> <li>- <u>Using Macro Indicators for Consistent CGE Baseline Construction</u> by <b>Ferrari, Emanuele</b>, Marc Mueller and Aida Gonzalez–Mellado</li> </ul>	<b>Lawang</b>

## Conference Schedule: Friday, June 11

Presenters should arrive 10 minutes early to their session room with their presentation on a USB drive.  
Presenters are denoted in bold.

Time	Event	Location
<b>08:30-10:30</b>	<b>Session 34</b> <b>“Taxes and Fiscal Policy”</b> Chair: Nico van Leeuwen  - <u>An Economy-wide Analysis of Consumption Voucher Policy in Taiwan</u> by Lee, Duuhwa, Ching-Cheng Chang and <b>Shih-Hsun Hsu</b>  - <u>The Impacts of Direct Tax Reform on Taiwan's Economy-A Computable General Equilibrium Analysis</u> by Lin, Yu-Hui, <b>Chen Dickens J. Chen</b> , Ching-Cheng Chang and Shih-Hsun Hsu  - <u>Moving to Goods and Services Tax in India: Impact on India's International Trade</u> by <b>Chadha, Rajesh</b> , Anjali Tandon and Ashwani	<b>Pala</b>
<b>10:30-11:00</b>	<b>Break</b>	<b>Pre-Cocktail Area</b>
<b>11:00-12:30</b>	<b>Session 35 – Organized Session</b> <b>“Data and analysis of global economic integration”</b> Organizer/Chair: Bob Koopman  - <u>Value Chains in Global Production Networks: An Application of Global Input-Output Tables</u> by <b>Powers, William</b> , Zhi Wang, Bob Koopman and Shang-Jin Wei  - <u>A General Equilibrium Analysis of the China-ASEAN Free Trade Agreement</u> by <b>Tsigas, Marinos</b> and Zhi Wang  - <u>A Time Series Database for Global Trade, Production and Consumption Linkages</u> by <b>Wang, Zhi</b> , Marinos Tsigas, Jesse Mora, Xin Li and Daniel Xu  - Discussants: Robert McDougall and Will Martin	<b>Pandan</b>

## Conference Schedule: Friday, June 11

Presenters should arrive 10 minutes early to their session room with their presentation on a USB drive.  
Presenters are denoted in bold.

Time	Event	Location
11:00-12:30	<p><b>Session 36 – Roundtable Discussion Session</b>  <b>“Asia as a locomotive of growth”</b>  Organizer: Asian Development Bank  Chair: Guntur Sugiyarto</p> <ul style="list-style-type: none"> <li>- Exchange Rate Policies and Economic Growth in Asia by <b>Zhai, Fan</b></li> <li>- The contribution of Asia’s middle class to growth by <b>Roland-Holst, David</b></li> <li>- Employment and Growth in Asia: What role of Trade and Informality? by <b>Sinha, Anushree</b></li> <li>- Fueling the Chinese Locomotive: Impact on Terms of Trade of Neighboring Countries by <b>Wittwer, Glyn</b></li> <li>- Changing Gears in the Locomotive by <b>Scollay, Robert</b></li> </ul>	<b>Halia</b>
11:00-12:30	<p><b>Session 37</b>  <b>“Agricultural Policies and Doha Round Negotiations”</b>  Chair: Aida Gonzalez-Mellado</p> <ul style="list-style-type: none"> <li>- <u>Trade Standards for Welfare Maximization: A Case of Indo-US Trade in Wheat and Mango</u> by <b>Rastogi, Siddhartha</b></li> <li>- <u>Modeling the agricultural employment development within the CGE framework: the consequences for policy responses</u> by <b>Tabeau, Andrzej</b> and Geert Woltjer</li> </ul>	<b>Jintan</b>

## Conference Schedule: Friday, June 11

Presenters should arrive 10 minutes early to their session room with their presentation on a USB drive.  
Presenters are denoted in bold.

Time	Event	Location
11:00-12:30	<b>Session 38</b> <b>“Financial Crisis and Free Trade Agreements”</b> Chair: Angel Aguiar  - <u>Trade and Sectoral Impacts of the Financial Crisis: A Dynamic CGE Analysis</u> by <b>Walmsley, Terrie</b> and Anna Strutt  - <u>What Can a CGE Say about the Housing Bubble Burst Crisis and Global Imbalances?</u> by <b>Lemelin, André</b> , Veronique Robichaud and Bernard Decaluwe  - <u>The Economic Impact of the Thailand-Australia Free Trade Agreement (TAFTA) and the Thailand-New Zealand Closer Economics Partnership (TNZCEP)</u> by <b>Wittayarungruang Sri, Sarut</b> , Rachda Chiasakul and Chotiga Khanti-Akom	Lawang
11:00-12:30	<b>Session 39</b> <b>“Free Trade Agreements”</b> Chair: Betina Dimaranan  - <u>Estimating the Medium-term Effects of the ASEAN Economic Community</u> by <b>Lee, Hiro</b> and Michael Plummer  - <u>Benchmarking the synergistic effect of China-ASEAN seaport industry development</u> by <b>Liao, Mei</b> , Weiwei Yang and Huizheng Liu  - <u>India-Japan FTA in Goods: A Partial and General Equilibrium Analysis</u> by <b>Ahmed, Shahid</b>	Pala
12:30-14:00	<b>Lunch</b>	<b>Tamarind Brasserie (PARKROYAL)</b>

## Conference Schedule: Friday, June 11

Presenters should arrive 10 minutes early to their session room with their presentation on a USB drive.  
Presenters are denoted in bold.

Time	Event	Location
14:00-16:00	<b>Session 40</b> <b>“Trade Liberalization and Latin America”</b> Chair: Masakazu Watanuki  - <u>Tear Down this Wall: On the Persistence of Borders in Trade</u> by <b>Nitsch, Volker</b> and Nikolaus Wolf  - <u>Flexibilities in Negotiations on Non-Agricultural Products</u> by <b>Jean, Sébastien</b> , Will Martin and David Laborde  - <u>Economic loss to the Brazilian regions due to the Doha Round failure: an investigation using bound tariffs</u> by Pereira, Matheus Wemerson G., <b>Erly Teixeira</b> and Angelo Gurgel  - <u>Assessing the Impact of Non-Tariff Barriers during the Global Crisis: The Experience in Argentina, Ecuador and Venezuela</u> by <b>Durán Lima, José Elías</b> , Carlos De Miguel, Mauricio Pereira and Gonzalo Veliz	<b>Andaman Grand Ballroom</b>
14:00-16:00	<b>Session 41 – Organized Session</b> <b>“Global Financial and Economic Crisis: Responses from the Asian Developing Countries”</b> Organizer/Chair: Selim Raihan  - <u>Global Economic Crisis: Implications for the Bangladesh Economy</u> by <b>Raihan, Selim</b>  - <u>Global Financial Crisis, MDGs and Choices for Pakistan’s Inclusive Development</u> by <b>Ahmed, Vaqar</b> and Ahsan Abbas  - <u>Global economic crisis, gender and poverty in the Philippines</u> by <b>Corong, Erwin</b>  - <u>Global Financial and Economic Crisis: Implications for Trade and Industrial Restructuring in South Asia</u> by <b>De, Prabir</b> and Chiranjib Neogi	<b>Pandan</b>

## Conference Schedule: Friday, June 11

Presenters should arrive 10 minutes early to their session room with their presentation on a USB drive.  
Presenters are denoted in bold.

Time	Event	Location
14:00-16:00	<b>Session 42</b> <b>“China and Mongolia”</b> Chair: Shih-Hsun Hsu <ul style="list-style-type: none"> <li>- <u>The Economic Impact of H1N1 Pandemic in Taiwan-A Computable General Equilibrium Analysis</u> by <b>Chang, Chin-Hsiue</b>, Hsing-Chun Lin, Ching-Cheng Chang and Shih-Hsun Hsu</li> <li>- <u>Recent Trends in Mongolian Foreign Trade with Northeast Asian Countries</u> by <b>Shagdar, Enkhbayar</b></li> <li>- <u>Predicting Expenditure Patterns across provinces in China based on AIDADS demand system</u> by <b>He, Jianwu</b> and Shantong Li</li> </ul>	<b>Halia</b>
14:00-16:00	<b>Session 43</b> <b>“Economic Crisis and Business Cycles”</b> Chair: Janine Pelikan <ul style="list-style-type: none"> <li>- <u>The Impact of EU Integration on Loan Default Rates</u> by Ciaian, Pavel, Jarko Fidrmuc, <b>d'Artis Kancs</b> and Jan Pokrivcak</li> <li>- <u>The availability and cost of short-term trade finance and its impact on trade</u> by <b>Korinek, Jane</b>, Jean Le Cocguic and Patricia Sourdin</li> <li>- <u>Business Cycle Persistence in Developing Countries: Can a DSGE Model with Production Chains and Sticky Prices Reproduce the Stylised Facts?</u> by <b>Male, Rachel</b></li> <li>- <u>Trade and income effects of policy measures taken in response to the economic crisis</u> by <b>van Tongeren, Frank</b></li> </ul>	<b>Jintan</b>

## Conference Schedule: Friday, June 11

Presenters should arrive 10 minutes early to their session room with their presentation on a USB drive.  
Presenters are denoted in bold.

Time	Event	Location
14:00-16:00	<b>Session 44</b> <b>“China and India”</b> Chair: Rajesh Chadha <ul style="list-style-type: none"> <li>- <u>The Growth of China and India: Implications and Policy Reform Options for Malaysia</u> by Ianchovichina, Elena, <b>Maros Ivanic</b> and Will Martin</li> <li>- <u>Can Trade Liberalization Promote Growth in Agriculture: Evidence from China and India</u> by <b>Deb, Surajit</b></li> <li>- <u>Doha Round Impacts on India</u> by Raihan, Selim and <b>Bazlul Khondker</b></li> <li>- <u>Regional disparity and Mitigation cost for carbon policy in China Assessment based on multi-regional CGE model</u> by <b>Li, Shantong</b> and Jianwu He</li> </ul>	<b>Lawang</b>
14:00-16:00	<b>Session 45</b> <b>“European Trade Policy”</b> Chair: Joe Francois <ul style="list-style-type: none"> <li>- <u>Adoption of GM Food Crop Varieties in the European Union</u> by <b>Jensen, Hans Grinsted</b> and Morten Gylling</li> <li>- <u>The Common Agricultural Policy and the French, European and World Economies</u> by <b>Boulangier, Pierre H</b>, Patrick Jomini, Xiao-Guang Zhang, Catherine Costa and Michelle Osborne</li> <li>- <u>What are the benefits of deepening trade integration in Europe?</u> by <b>Aussilloux, Vincent</b>, Lionel Fontagné and Charlotte Emlinger</li> <li>- <u>A quantitative economic assessment of a Canada-EU Comprehensive Economic Trade Agreement</u> by <b>Kitou, Elisavet</b> and George Philippidis</li> </ul>	<b>Pala</b>
16:00-16:30	<b>Break</b>	<b>Pre-Cocktail Area</b>

## Conference Schedule: Friday, June 11

Presenters should arrive 10 minutes early to their session room with their presentation on a USB drive.  
Presenters are denoted in bold.

<b>Time</b>	<b>Event</b>	<b>Location</b>
<b>16:30-18:00</b>	<b>Plenary Session</b> <b>“Climate Change”</b> Chair: Wally Tyner  - <u>The modeling of the economics of climate change: Stocktaking and future challenges</u> by <b>van der Mensbrughe, Dominique</b>  - <u>Intergenerational equity, risk and climate modeling</u> by <b>Quiggin, John</b>	<b>Andaman Grand Ballroom</b>
<b>18:00-18:15</b>	<b>2011 Conference Preview</b> Francesco Bosello and Angela Marigo	<b>Andaman Grand Ballroom</b>
<b>18:15-18:30</b>	<b>Closing Remarks</b> Terrie Walmsley and Mia Mikic	<b>Andaman Grand Ballroom</b>



## 2011 Conference Preview

### Fourteenth Annual Conference on Global Economic Analysis “Global Governance”



Venice, Italy  
June 2011

#### Objective

The objective of the annual conference on economic analysis is to promote the exchange of ideas among economists conducting quantitative analysis of global economic issues. Particular emphasis will be placed on applied general equilibrium methods, data, and application. Related theoretical and applied work is also welcome. This conference will focus the environment and climate, trade, distributional and equity issues, dynamics and growth, energy supply and security, international health issues, poverty and development, crime and wars, methodology, software and data.

#### Abstract / Session Proposal Submission

Abstracts, organized and roundtable discussion session proposals will be accepted on the GTAP website from early November 2010 through January 15, 2011. All abstracts and proposals will go through a standard review process. The accepted presenters will be notified in early March 2011 with papers due by April 15, 2011.

If you have any questions on this event, please do not hesitate to contact:

**Meghan Alexander**  
[megalex@purdue.edu](mailto:megalex@purdue.edu)  
Program Manager  
Center for Global Trade Analysis  
Department of Agricultural Economics  
Purdue University

## Conference Participant List

Full contact information for participants may be accessed on the GTAP website.

### **Ahsan Abbas**

GIFT University Gujranwala  
Pakistan  
ahsan.abbas@gift.edu.pk

### **Angel H. Aguiar**

Purdue University  
United States  
aaguiar@purdue.edu

### **Shahid Ahmed**

Jamia Millia Islamia  
India  
shahec@gmail.com

### **Amer Ahmed**

The World Bank  
United States  
sahmed20@worldbank.org

### **Vaqar Ahmed**

Planning Commission  
Pakistan  
vahmed@gmail.com

### **Emmanuel Akande**

University of Lagos  
Nigeria  
gynoscentos@yahoo.com

### **Meghan Alexander**

Purdue University  
United States  
megalex@purdue.edu

### **Syarifah Amaliah**

Bogor Agricultural University  
Indonesia  
samaliah56@gmail.com

### **Kym Anderson**

The University of Adelaide  
Australia  
kym.anderson@adelaide.edu.au

### **Vincent Aussilloux**

European Commission (EC)  
UK Department for Business, Innovation and Skills  
United Kingdom  
vincent.aussilloux@bis.gsi.gov.uk

### **Ginger Batta**

Purdue University  
United States  
gbatta@purdue.edu

### **Eddy Bekkers**

University of Linz  
Austria  
eddybekkers@gmail.com

### **Sami Bensassi**

University Jaume 1  
Spain  
bensassi@uji.es

### **Andrew Bernard**

Dartmouth College  
United States  
andrew.b.bernard@tuck.dartmouth.edu

### **Jiang Bing**

China  
jiang4060916@126.com

### **Francesco Bosello**

FEEM  
Italy  
francesco.bosello@feem.it

### **Antoine Bouët**

International Food Policy Research Institute  
United States  
a.bouet@cgiar.org

### **Pierre Boulanger**

GEM Sciences Po - Goethe Universität  
France  
pierre.h.boulanger@gmail.com

### **Wolfgang Britz**

University of Bonn  
Germany  
wolfgang.britz@ilr.uni-bonn.de

### **Martina Brockmeier**

University of Hohenheim  
Germany  
martina.brockmeier@uni-hohenheim.de

### **Alvaro Calzadilla**

Kiel Institute for the World Economy  
Germany  
alvaro.calzadilla@gmail.com

**Jing Cao**

Tsinghua University  
China  
caojing@sem.tsinghua.edu.cn

**Liangyue Cao**

Department of Treasury  
Australia  
lic@treasury.gov.au

**Lucian Cernat**

DG Trade, European Commission  
Belgium  
lucian.cernat@ec.europa.eu

**Rajesh Chadha**

NCAER  
India  
rchadha@ncaer.org

**Chin-Hsiue Chang**

NTU  
Taiwan (ROC)  
f94627002@ntu.edu.tw

**Angus Charteris**

New Zealand Ministry of Foreign Affairs and Trade  
New Zealand  
gus.charteris@mfat.govt.nz

**Jean Chateau**

OECD  
France  
jean.chateau@oecd.org

**Amrita Chatterjee**

National Council of Applied Economic Research  
India  
achatterjee@ncaer.org

**Saswata Chaudhury**

The Energy and Resources Institute (TERI)  
India  
saswatac@teri.res.in

**Kornkarun Cheewatrakoolpong**

Chulalongkorn University  
Thailand  
runechan@gmail.com

**Chen Dickens J. Chen**

National Taiwan University  
Taiwan (ROC)  
d95627005@ntu.edu.tw

**Yi-Chieh Chen**

Chung-Hua Institution for Economic Research  
National Taiwan University  
Taiwan (ROC)  
yichieh@cier.edu.tw

**Lan-Fen Chu**

Institute of Economics, Academia Sinica  
Taiwan (ROC)  
lfchu@econ.sinica.edu.tw

**Erwin Corong**

Monash University  
Australia  
erwincorong@yahoo.com

**Prabir De**

RIS  
India  
prabirde@hotmail.com

**Alan Deardorff**

University of Michigan  
United States  
alandear@umich.edu

**Surajit Deb**

Ram Lal Anand College, University of Delhi  
India  
debsurajit@gmail.com

**Elisa Dienesch**

CATT, University of Pau  
France  
elisa.dienesch@gmail.com

**Betina Dimaranan**

IFPRI - MTID  
United States  
b.dimaranan@cgiar.org

**Huong Dinh**

ANU  
Australia  
huong.dinh@anu.edu.au

**Evan Due**

International Development Research Centre  
Singapore  
edue@idrc.org.sg

**José Elías Durán Lima**

ECLAC, United Nations  
Ecuador  
jose.duran@cepal.org

**Seun Moses Durodola**  
Oluyole Local Govt  
Nigeria  
dkejis2009@gmail.com

**Fabio Eboli**  
FEEM - Fondazione Eni Enrico Mattei  
Italy  
fabio.eboli@feem.it

**Aziz Elbehri**  
Food and Agriculture Organization of the United Nations  
Italy  
aziz.elbehri@fao.org

**H. David Evans**  
Sussex European Institute (SEI)  
United Kingdom  
hde20@sussex.ac.uk

**Emanuele Ferrari**  
IPTS-JRC  
Spain  
emanuele.ferrari@ec.europa.eu

**Joaquim Bento Ferreira-Filho**  
Escola Superior de Agricultura Luiz de Queiroz  
Brazil  
jbsferre@esalq.usp.br

**Jason Fong**  
Ratings Agency Malaysia  
Malaysia  
jason@ram.com.my

**Kristina Fong**  
RAM Holdings Bhd  
Malaysia  
kristina.fong@gmail.com

**Lionel Fontagné**  
Paris School of Economics, Université Paris 1 / CEPPII  
France  
lionel.fontagne@univ-paris1.fr

**Mohammad Hassan Fotros**  
Bu-Ali Sina University  
Iran  
fotros@basu.ac.ir

**Joseph Francois**  
Johannes Kelper University  
Austria  
joseph.francois@jku.at

**Masahisa Fujita**  
Research Institute of Economy, Trade and Industry  
Japan  
fujita-masahisa@rieti.go.jp

**Tani Fukui**  
USITC  
United States  
tani.fukui@usitc.gov

**Richard Garbaccio**  
US Environmental Protection Agency (EPA)  
United States  
garbaccio.richard@epa.gov

**John Gilbert**  
Utah State University  
United States  
jgilbert@econ.usu.edu

**Alla Golub**  
Purdue University  
United States  
golub@purdue.edu

**Aida Gonzalez-Mellado**  
Institute for Prospective Technological Studies  
Spain  
aidaagm@yahoo.com.mx

**Robert Grundke**  
UN ECLAC and IFW Kiel  
United States  
robert.grundke@gmx.de

**Sharina Farihah Hasan**  
International Islamic University Malaysia  
Malaysia  
sfarihah@iiu.edu.my

**Jianwu He**  
Development Research Center of State Council  
China  
jianwu@drc.gov.cn

**Ben Henderson**  
FAO  
Italy  
benjamin.henderson@fao.org

**Thomas Hertel**  
Purdue University  
United States  
hertel@purdue.edu

**Fajar Hidayat**  
Delegation of European Union to Indonesia  
Indonesia  
fajar.hidayat@ec.europa.eu

**Nobuhiro Hosoe**  
National Graduate Institute for Policy Studies  
Japan  
nhosoe@grips.ac.jp

**Shih-Hsun Hsu**

National Taiwan University  
Taiwan (ROC)  
m577@ntu.edu.tw

**Ellen Huan-Niemi**

MTT Agrifood Research Finland  
Finland  
ellen.huan-niemi@mtt.fi

**Sadequl Islam**

Laurentian University  
Canada  
sislam@laurentian.ca

**Normaz Wana Ismail**

Universiti Putra Malaysia  
Malaysia  
nwi@econ.upm.edu.my

**Koji Ito**

Research Institute of Economy, Trade and Industry  
Japan  
ito-koji@rieti.go.jp

**Maros Ivanic**

United States  
ivanic@gmail.com

**Sébastien Jean**

CEPII / INRA  
France  
sebastien.jean@grignon.inra.fr

**Hans Grinsted Jensen**

Institute of Food and Resource Economics (FOI)  
Denmark  
hans@foi.dk

**Michael Jerie**

GEMPACK  
Australia  
michael.jerie@buseco.monash.edu.au

**Patrick Jomini**

Productivity Commission  
Australia  
pjomini@pc.gov.au

**Masaru Kagatsume**

Kyoto University  
Japan  
kagatsume@kais.kyoto-u.ac.jp

**d'Artis Kancs**

Catholic University of Leuven  
Belgium  
dartis.kancs@econ.kleuven.be

**Zhanna Kapsalyamova**

Christian Albrechts University of Kiel  
Germany  
kapsalyamova@yahoo.com

**Farzad Karimi**

Iran  
farzadkarimi@mau.ac.ir

**Stephen Karingi**

United Nations Economic Commission for Africa  
Ethiopia  
Skaringi@uneca.org

**Ken Kawasaki**

Research Institute of Economy, Trade and Industry  
Japan  
kawasaki-kenichi@rieti.go.jp

**Bazlul Khondker**

Dhaka University  
Bangladesh  
bazlul.khondker@gmail.com

**Jouko Kinnunen**

Government Institute for Economic Research  
Finland  
jouko.kinnunen@vatt.fi

**Elisavet Kitou**

DEFRA  
United Kingdom  
elisavet.kitou@defra.gsi.gov.uk

**Andra Koke**

European Commission  
Belgium  
Andra.koke@ec.europa.eu

**Bob Koopman**

US International Trade Commission (USITC)  
United States  
robert.koopman@usitc.gov

**Jane Korinek**

OECD  
France  
jane.korinek@oecd.org

**Marijke Kuiper**

LEI, Wageningen University and Research Centre  
The Netherlands  
Marijke.Kuiper@wur.nl

**David Laborde**

IFPRI  
United States  
d.laborde@cgiar.org

**Csilla Lakatos**  
Purdue University  
United States  
clakatos@purdue.edu

**Maria C Latorre**  
University Complutense of Madrid  
Spain  
cmlatorre@estad.ucm.es

**Hiro Lee**  
Osaka University  
Japan  
hlee@osipp.osaka-u.ac.jp

**Amanda Leister**  
Purdue University  
United States  
aleister@purdue.edu

**André Lemelin**  
Université du Québec, INRS-UCS  
Canada  
andre\_lemelin@ucs.inrs.ca

**Shantong Li**  
Development Research Center  
China  
shantong@drc.gov.cn

**Mei Liao**  
Beijing University of Technology  
China  
liaomei@bjut.edu.cn

**Hsing-Chun Lin**  
National Chiayi University  
Taiwan (ROC)  
hclin@mail.ncyu.edu.tw

**Huizheng Liu**  
Beijing University of Technology  
China  
liuhuizheng@bjut.edu.cn

**Patrick Low**  
World Trade Organization (WTO)  
Switzerland  
patrick.low@wto.org

**Helene Maisonnave**  
Financial and Fiscal Commission  
South Africa  
hmaisonnave@hotmail.fr

**Rachel Male**  
Queen Mary, University of London  
United Kingdom  
r.male@qmul.ac.uk

**Angela Marigo**  
Fondazione Eni Enrico Mattei  
Italy  
angela.marigo@feem.it

**Alexandra Marques**  
Instituto Superior Técnico  
Portugal  
alexandra.marques@ist.utl.pt

**Will Martin**  
The World Bank  
United States  
wmartin1@worldbank.org

**Kimmo Marttila**  
Government Institute of Economic Research  
Finland  
kimmo.marttila@vatt.fi

**Robert McDougall**  
Purdue University  
United States  
mcdougar@purdue.edu

**Maximiliano Méndez Parra**  
University of Sussex  
United Kingdom  
mm273@sussex.ac.uk

**Mia Mikic**  
UN ESCAP  
Thailand  
mikic@un.org

**Mondher Mimouni**  
International Trade Centre  
Switzerland  
mimouni@intracen.org

**Peter Minor**  
Consulting Economist  
United States  
PeteMinor@comcast.net

**Tasneem Mirza**  
Asian Development Bank  
Philippines  
tmirza@adb.org

**Maria Cristina Mitaritonna**  
CEPII  
France  
cristina.mitaritonna@cepii.fr

**Thordis Moeller**  
Humboldt University Berlin  
Germany  
thordis.moeller@agrar.hu-berlin.de

**Zarina Mohammad**  
Universiti Putra Malaysia  
Malaysia  
zarina.rmohd@gmail.com

**Javier Montano**  
Kyoto University  
Bolivia  
jmontano@biociencias.org

**Marc Mueller**  
University of Bonn  
Germany  
marcmolinero@gmail.com

**Tomoyoshi Nakajima**  
ERINA  
Japan  
nakajima.tomoyoshi.20@erina.or.jp

**Ganesh Nana**  
Business and Economic Research Ltd (BERL)  
New Zealand  
ganesh.nana@berl.co.nz

**Gladys Navarro**  
Saint Louis University  
Philippines  
gladmanav@yahoo.com

**Alessandro Nicita**  
UNCTAD  
Switzerland  
Alessandro.Nicita@unctad.org

**Janne Niemi**  
Government Institute for Economic Research  
Finland  
janne.niemi@vatt.fi

**Lars Nilsson**  
European Commission (EC)  
Belgium  
lars.nilsson@ec.europa.eu

**Volker Nitsch**  
TU Darmstadt  
Germany  
nitsch@vwl.tu-darmstadt.de

**Hildegunn Nordas**  
OECD  
France  
hildegunn.nordas@oecd.org

**J. Alexander Nuetah**  
China Agriculture University  
China  
janu257@gmail.com

**Rina Oktaviani**  
Bogor Agricultural University  
Indonesia  
r\_oktavi@indo.net.id

**Christopher Onyango**  
Kenya Institute for Public Policy Research and Analysis  
Kenya  
conyango@kippra.or.ke

**Anton Orlov**  
University Hohenheim  
Germany  
orlov@uni-hohenheim.de

**Sergey Paltsev**  
Joint Program on the Science and Policy of Global Change  
United States  
paltsev@mit.edu

**Hom Pant**  
ABARE  
Australia  
hom.pant@abare.gov.au

**Ramiro Parrado**  
Ca' Foscari University of Venice and FEEM  
Italy  
ramiro.parrado@feem.it

**Gloria Pasadilla**  
Asian Development Bank Institute  
Japan  
gpsadilla@adbi.org

**Valerien Pede**  
IRRI  
Philippines  
pvalerien@yahoo.fr

**Janine Pelikan**  
Johann Heinrich von Thünen Institute (vTI)  
Germany  
janine.pelikan@vti.bund.de

**Ralf Peters**  
International Labour Organization  
Switzerland  
peters@ilo.org

**Kyophilavong Phouphet**  
National University of Laos  
Laos  
phouphet20007@hotmail.com

**Roberta Piermartini**  
WTO Geneva  
Switzerland  
roberta.piermartini@wto.org

**William Powers**

U.S. International Trade Commission  
United States  
william.powers@usitc.gov

**John Quiggin**

University of Queensland  
Australia  
johnquiggin1@mac.com

**Selim Raihan**

University of Dhaka  
Bangladesh  
selim.raihan@gmail.com

**Melanie Ramjoue**

UN ESCAP  
Thailand  
Ramjoue@un.org

**Siddhartha Rastogi**

Indian Institute of Management Ahmedabad  
India  
srastogi@iimahd.ernet.in

**Ravindra Ratnayake**

UN ESCAP  
Thailand  
Ratnayaker@un.org

**Veronique Robichaud**

CIRPEE Université Laval  
Canada  
veronique.robichaud@hec.ca

**Peter Robleh Gabriel**

United Nations Economic Commission for Africa  
Ethiopia  
probleh@uneca.org

**Nadia Rocha**

WTO  
Switzerland  
nadia.rocha@wto.org

**Hugo Rojas-Romagosa**

Netherlands Bureau for Economic Policy Analysis  
Costa Rica  
h.rojas-romagosa@cpb.nl

**Sawkut Rojid**

World Bank  
Mauritius  
sawkutrojid@yahoo.com

**David Roland-Holst**

University of California  
United States  
dwrh@are.berkeley.edu

**Renato Rosa**

FEEM  
Italy  
renato.nunesrosa@feem.it

**Roberto Roson**

Ca' Foscari University  
Italy  
roson@unive.it

**Rizaudin Sahlan**

Universiti Utara Malaysia  
Malaysia  
riz@uum.edu.my

**Martina Sartori**

University of Milan and IFEF-Bocconi University  
Italy  
martina.sartori@unimi.it

**Christoph Schmitz**

Potsdam Institute for Climate Impact Research  
Germany  
schmitz@pik-potsdam.de

**Robert Scollay**

University of Auckland  
New Zealand  
r.scollay@auckland.ac.nz

**Enkhbayar Shagdar**

Economic Research Institute for Northeast Asia (ERINA)  
Japan  
enkhee@erina.or.jp

**Khalid Siddig**

Khartoum University  
Sudan  
khalidhasiddig@yahoo.com

**Anushree Sinha**

National Council of Applied Economic Research (NCAER)  
India  
asinha@ncaer.org

**Noleen Sithole**

North West University  
South Africa  
21246165@nwu.ac.za

**Dean Spinanger**

Kiel Institute for the World Economy  
Germany  
dspinanger@googlemail.com

**Anna Strutt**

University of Waikato  
New Zealand  
astrutt@waikato.ac.nz



**Eric Suan**

Asian Development Bank (ADB)  
Philippines  
esuan@adb.org

**Guntur Sugiyarto**

Asian Development Bank  
Philippines  
gsugiyarto@adb.org

**Mphumuzi Sukati**

University of Nottingham  
United Kingdom  
mphumuzi@hotmail.com

**Wojtek Szewczyk**

European Commission, Joint Research Centre  
Spain  
wojciech.szewczyk@ec.europa.eu

**Andrzej Tabeau**

Agricultural Economics Research Institute (LEI)  
The Netherlands  
andrzej.tabeau@wur.nl

**Akbar Tavakoli**

Isfahan University Of Technology  
Iran  
atavakoli@cc.iut.ac.ir

**Erly Teixeira**

Universidade Federal de Viçosa  
Brazil  
teixeira@ufv.br

**Edward Tower**

Duke University  
United States  
edward.tower@duke.edu

**Marinos Tsigas**

US International Trade Commission (USITC)  
United States  
marinos.tsigas@usitc.gov

**Wally Tyner**

Purdue University  
United States  
wtyner@purdue.edu

**Willem van der Geest**

International Trade Centre  
Switzerland  
vandergeest@intracen.org

**Dominique van der Mensbrugghe**

The World Bank  
United States  
dvandermensbrugghe@worldbank.org

**Nico van Leeuwen**

Netherlands Bureau for Economic Policy Analysis  
The Netherlands  
nimvl@cpb.nl

**Frank van Tongeren**

OECD  
France  
frank.vantongeren@oecd.org

**David Vanzetti**

Australian National University  
Australia  
david.vanzetti@anu.edu.au

**Utpal Vasavada**

USDA, ERS  
United States  
vasavada@ers.usda.gov

**Monika Verma**

Purdue University  
United States  
verma3@purdue.edu

**Terrie Walmsley**

Purdue University / University of Melbourne  
Australia  
twalmsle@purdue.edu

**Zhi Wang**

US International Trade Commission (USITC)  
United States  
zhi.wang@usitc.gov

**Masakazu Watanuki**

Inter-American Development Bank (IDB)  
United States  
masakazuw@iadb.org

**Stefan Westerberg**

The National Board of Trade  
Sweden  
Stefan.Westerberg@kommers.se

**Suthin Wianwivat**

Khon Kaen University  
Australia  
suthin.wianwivat@uqconnect.edu.au

**Niven Winchester**

Massachusetts Institute of Technology  
University of Otago  
United States  
niven@mit.edu

**Tony Wiskich**

Frontier Economics  
Australia  
tony.wiskich@frontier-economics.com.au

**Sarut Wittayarungruang**

Sarut Wittayarungruang  
Bryan Cave (Thailand), Ltd.  
Thailand  
sarut.wittayarungruang@bryancavetrade.com

**Glyn Wittwer**

Centre of Policy Studies  
Australia  
glyn.wittwer@buseco.monash.edu.au

**Weiwei Yang**

Beijing University of Technology  
China  
yangww@bjut.edu.cn

**Kim Leng Yeah**

RAM Holdings Berhad  
Malaysia  
yeah@ram.com.my

**Tey (John) Yeong-Sheng**

Institute of Agricultural and Food Policy Studies  
Malaysia  
tyeong.sheng@gmail.com

**Ke Fei You**

London Metropolitan University  
United Kingdom  
k.you@londonmet.ac.uk

**Zulkornain Yusop**

Universiti Putra Malaysia  
Malaysia  
zulkornain.yusop@gmail.com

**Chahir Zaki**

University of Paris 1 - Paris School of Economics  
France  
chahir\_zaki@yahoo.com

**Fan Zhai**

China Investment Corporation  
China  
zhaifan@china-inv.cn

**Juzhong Zhuang**

Asian Development Bank  
Philippines  
jzhuang@adb.org



**Center for Global Trade Analysis**  
Department of Agricultural Economics  
Purdue University  
403 West State Street  
West Lafayette, Indiana 47907-2056  
United States

Ph: +1 765-494-4267  
Fx: +1 765-496-1224  
Em: [contactgtap@purdue.edu](mailto:contactgtap@purdue.edu)  
<http://www.gtap.agecon.purdue.edu>