



21st Annual Conference on Global Economic Analysis

*Framing the future through the
Sustainable Development Goals*



*Cartagena de Indias Convention Center
Cartagena, Colombia
June 13-15, 2018*

 [@GTAP_Purdue](https://twitter.com/GTAP_Purdue)
[#GTAPConference](https://twitter.com/GTAPConference)

Center for Global Trade Analysis
Purdue University



**Universidad
de Cartagena**
Fundada en 1827

PROGRAM CONTENTS

GENERAL INFORMATION2

CONFERENCE APP and SOCIAL MEDIA.....3

CONFERENCE ORGANIZERS and SPONSORS4

 Organizers.....4

 Sponsors4

SPECIAL RECOGNITION5

 Co-Chairs5

 Program Committee Members.....5

 Abstract Reviewers.....5

 Conference Mentors5

KEN PEARSON TRAVEL FUNDS6

ALEX MEERAUS / THOMAS RUTHERFORD TRAVEL FUNDS.....7

TRANSPORTATION9

 Rafael Nuñez International Airport.....9

 Taxis and Uber9

CONFERENCE VENUES.....10

 Locations / Distances.....10

 Walking Directions.....10

 Convention Center WiFi.....11

 Convention Center Floor Plans.....11

WEDNESDAY, JUNE 1312

 Session Overview.....12

 Distinguished Plenary Speaker.....13

 Presentation Schedule.....14

THURSDAY, JUNE 1425

 Session Overview.....25

 Distinguished Plenary Speaker.....26

 Presentation Schedule.....27

FRIDAY, JUNE 1538

 Session Overview.....38

 Distinguished Plenary Speaker.....39

 Presentation Schedule.....40

SATURDAY, JUNE 1644

 Post-Conference Event.....44

PARTICIPANT LIST.....45

SESSION PARTICIPANT INDEX.....52

2019 CONFERENCE PREVIEW55

NOTES56

GENERAL INFORMATION

Objective

The goal of the annual conference on economic analysis is to promote the exchange of ideas among economists conducting quantitative analysis of global economic issues.

Format

The majority of the conference features specially organized and contributed paper sessions. The organized sessions have been developed by members of the GTAP Network to highlight a specific area of research and/or policy analysis. The contributed paper sessions were selected through a peer review process and subsequently grouped to reflect the varied themes being addressed by members of the GTAP Network.

The conference will also include plenary sessions, each featuring distinguished intellectual leaders in their respective fields whose presentations are designed to introduce participants to new topics as well as provide fresh insights into familiar ones. The content of these sessions reflects the overall conference themes.

"Framing the future through the Sustainable Development Goals"

- Technology, wages and growth
- The changing architecture of trade policies
- Energy transformation—winners and losers
- Challenges to achieving the sustainable development goals

Papers from each session can be accessed through the conference homepage on the GTAP website:

www.gtap.agecon.purdue.edu/events/conferences/2018/ ISSN 2160-2115 (online)

CONFERENCE APP and SOCIAL MEDIA



Whova is a free mobile app containing conference program information and facilitating schedule update notifications and attendee engagement. iOS and Android users can download the Whova app through their device's app store. To get started, follow the steps below.

Step 1 - Download Whova App



Step 2 - Tap "Find Your Event"



Step 3 - Search for "GTAP", tap result



Step 4 - Tap "Join"



Step 5 - Log in using your email



Step 6 - Enjoy the conference!

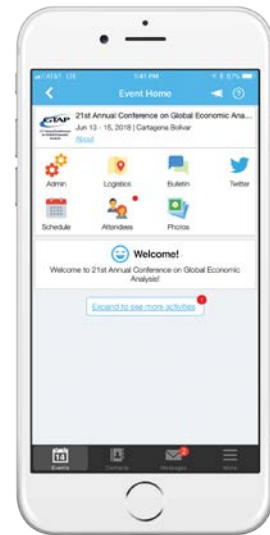

Invitation code: gtap18 (if prompted)

Other Useful Notes

- Be sure to allow push notifications from Whova to ensure you receive schedule updates and other communication during the conference.
- GTAP's social media is linked through Whova. Tweet us during the conference!



CONFERENCE ORGANIZERS and SPONSORS

Organizers



**Center for Global Trade Analysis
Department of Agricultural Economics
Purdue University**

The Global Trade Analysis Project (GTAP) is a global network of researchers and policy makers conducting quantitative analysis of international policy issues within an economy-wide framework. GTAP is coordinated by the Center for Global Trade Analysis which is housed in the Department of Agricultural Economics at Purdue University. The Center for Global Trade Analysis' mission is to provide leadership in economic policy analysis through better data, fostering collaboration, and research. The centerpiece of Global Trade Analysis Project is the GTAP Data Base, a fully documented and publicly available, analytical data base for the global economy which contains detailed country data, linked through bilateral trade, transportation and protection. Accompanying this data base is a set of GTAP-based models used and developed by network members. The GTAP Data Base and analytical framework are used by thousands of researchers around the world. Originally, the majority of the research was related to international trade policy issues. Today, GTAP is still the most widely used tool for trade policy, but its use has expanded into poverty, international migration, foreign investment, climate change, environment, energy, and biofuel policies. GTAP has become a common "language" for many of those conducting analysis of global policy issues with GTAP-based results becoming increasingly influential in decision making around the world in trade, climate change, energy and the environment.

www.gtap.agecon.purdue.edu



**Economics and Social Research Department
Faculty of Economic Sciences
Universidad de Cartagena**

Universidad de Cartagena is a public university located in the northern region of Colombia. Its main campus is located in Cartagena de Indias D.T. y C. (Bolívar) with a system that has statewide campuses in the Bolívar region and a wide range of academic programs, including distance learning programs, and adult-learning programs. Founded in 1827, initiated with the Schools of Medicine, Law and Philosophy, which had a key role in shaping ideas of national leaders that help to the construction of the national State, such as former University President Rafael Nuñez that became President of Colombia in four times and who established the Colombian Constitution of 1886. In its 190-year anniversary, the leadership of Universidad de Cartagena still on progress by having a wide offer of undergraduate and graduate programs in the field of economics, engineering, science, health, law, education and human sciences, as a response to the needs of the Colombian society. The Economics and Social Research Department in the last 20 years has been part of the social and economic policy agenda of the Colombian Caribbean region by fostering collaboration with private and public institutions in the field of health economics, labour economics, environmental economics and public economics.

www.unicartagena.edu.co

Sponsors

- Center for Global Trade Analysis, Purdue University
- Universidad de Cartagena
- City of Cartagena
- Instituto de Patrimonio y Cultura de Cartagena
- Inter-American Development Bank

SPECIAL RECOGNITION

Co-Chairs

- **Dominique van der Mensbrugghe**, Director, Center for Global Trade Analysis, Purdue University
- **Andres Escobar**, Depto. de Investigaciones Económicas y Sociales, Facultad de Ciencias Económicas, Universidad de Cartagena

Program Committee Members

Angel Aguiar	Laurent Cretegnay	Russell Hillberry	Maria C. Latorre	Niven Winchester
Ricardo Arguello	Joaquim Bento	Stephen Karingi	Maryla Maliszewska	Katazyna Zawalińska
Onil Banerjee	Ferreira-Filho	Kenichi Kawasaki	Roberto Roson	
Martin Cicowiez	Angelo Gurgel	Zornitsa Kutlina-	Nelson Villoria	
Amanda Countryman	Thomas Hertel	Dimitrova	Terrie Walmsley	

Abstract Reviewers

Mustafa Acar	Jean Fouré	Ahangamage M. S. Perera	Enkhbayar Shagdar
Saad Ahmad	Florian Freund	Ken'ichi Matsumoto	Habtamu Shiferaw
Zeynep Akgul	Anand Ganesh-Kumar	Verena McClain	Khalid Siddig
Tariq Ali	Ziad Ghaith	Xue Meng	Mahinda Siriwardana
Katherine M. A. Sanjinez	Brad Gilmour	Simon Mevel	Nuno Sousa
Misak Avetisyan	Alex Gohin	Rebeca Miranda	Amanda Stamplecoskie
Lacina Balma	Alla Golub	Fulgence Mishili	Anjali Tandon
Seetha Bandara	Christophe Gouel	Abdulaziz Mosa	Isabel Teichmann
Andre Barbe	Houssein Guimbard	Ronie Nguenkwe	Tavishi Tewary
Güzin Bayar	Jinggang Guo	Mary Odongo	Natalia Tourdyeva
Bineswaree Bolaky	Jorge Hernandez	Masahiro Omura	Nhi Tran
Sudarshan Chalise	Marthe Hinojales	Diti Oudendag	Truong Truong
Maksym Chepeliev	Yiseok Hong	Kazuhiko Oyamada	Komi Tsowou
Caesar Cororaton	Fernando Izquierdo	Marcos Pena Júnior	Philip Tuano
Alma Cortes Selva	Hans Grinsted Jensen	Denise Penello-Rial	Vinicius Vale
Surajit Deb	Dora E. Jiménez Giraldo	Xiujian Peng	Hugo Valin
Hanna Deringer	Kayenat Kabir	Fernando Perobelli	Beatriz Velazquez
Abdoul Madjidi Diallo	Alexey Kravchenko	Everett Peterson	Mike Webb
Sumali Dissanayake	Vitaliy Krupin	Talita Pinto	Anton Yang
José Elías Durán Lima	Zornitsa Kutlina-Dimitrova	Krishna Poudel	Guolin Yao
Mingtai Fan	Jing Liu	Manitra A. Rakotoarisoa	Liu Yu
Emanuele Ferrari	Dmitry Lysenko	Jose M. Rueda-Cantucho	Wusheng Yu
James Fetzer	Aline Magalhaes	Amadou Sagnon	Cicero Zanetti De Lima
Lionel Fontagné	Paulo Mamede	Radford Schantz	Hainan Zhang

Conference Mentors

Philip Adams	Carmen Estrades	Kakali Mukhopadhyay	Roberto Roson
Onil Banerjee	Lucas Ferraz	Brian Mureverwi	Brent Sohngen
Robert Beach	Joaquim Bento Ferreira-	Badri Narayanan	Marco Springmann
Eddy Bekkers	Filho	Rehab O. M. Osman	Anna Strutt
Eduardo Bianchi	Eduardo Haddad	Israel Osorio Rodarte	Farzad Taheripour
Pierre H Boulanger	Meriem Hamdi-Cherif	Ramiro Parrado	Saara Tamminen
Mary Burfisher	Jong-Hwan Ko	Karl Pauw	Eryl Teixeira
Martin Cicowiez	Maria C. Latorre	Janine Pelikan	Marc Vielle
Erwin Corong	Jifeng Li	Adriana Peluffo	Chahir Zaki
Alan Deardorff	Maryla Maliszewska	Maureen Rimmer	
Peter Dixon	Marian Mraz	Hugo Rojas-Romagosa	

KEN PEARSON TRAVEL FUNDS



Ken Pearson's early career was as an outstanding mathematician. In the 1970s he became Reader and Chairman in Mathematics at La Trobe University, Australia. In his teaching role, he investigated the possibility of drawing on economics rather than physics for relevant examples. In this process he came across the newly emerging field of applied (or computable) general equilibrium modelling. Long before the economists, Ken recognized the need for software that would not only solve large scale economic models but would also be a vehicle: for organizing data; for analyzing results; for transferring models between researchers; and for storing models in a computationally accessible form which would allow them to be accessed at other times and by other researchers. By the mid-1980s he had responded to this need by taking up a visiting position at the Impact Research Centre (Melbourne University) and creating GEMPACK. In 1992, Ken moved to the Centre of Policy Studies (CoPS, then located at Monash University).

At CoPS, he was appointed Professorial Fellow in 1999, and held the position of Deputy Director from 2000 to 2004. He retired in 2014, with the position of Director, GEMPACK passing to Mark Horridge. Ken died of cancer on May 12, 2015. Throughout his illness, he was stoic, always cheerful, and grateful for a good life. In a summary of Ken's contribution to the GTAP, Tom Hertel wrote, *"Those of us who had the privilege of working closely with Ken count our collaborations with him as among the most stimulating and rewarding of our careers. Ken's keen intellect and his background in theoretical mathematics allowed him to quickly grasp the essence of whatever modeling challenge we posed."*

Funding Details

In recognition of the many contributions made by the late Professor Ken Pearson to the GTAP Network, the **Centre of Policy Studies, Victoria University** has graciously provided travel reimbursement funding in his name aimed to support the participation of promising young researchers at the GTAP Conference and encourage their contribution to the use and further development of analytical software for CGE modelling, following in his tradition. Recipient(s) were selected based on the following criteria.

- an early career researcher within five years of the start of their research career
- active in undertaking applied model-based analyses of real world problems using GEMPACK or related software
- paper accepted into the GTAP Conference



Recipient

The Centre of Policy Studies, Victoria University and the Center for Global Trade Analysis, Purdue University are pleased to announce the following recipient of the 2018 Ken Pearson Travel Funds.



Debora Freire

Professor at Federal University of Minas Gerais

Structural impacts of a cash transfer program: an application of a SAM based CGE model for Brazil
by Freire, Debora, Edson Domingues and Gustavo Britto
(Session #26, pg. 29)

Debora Freire holds a PhD in Economics from The Center for Development and Regional Planning (Cedeplar), in the Federal University of Minas Gerais, Brazil. She is currently Professor Assistant at the same university and affiliated as Junior Faculty at Cedeplar. Formerly, she was Visiting Scholar at the Regional Economics Applications Laboratory (REAL) at the University of Illinois at Urbana-Champaign, United States, and Post-doc Researcher at Cedeplar, Brazil.

She has been working as research consultant applying CGE modelling on projects funded by the United Nations Population Fund (UNFPA) and Government agencies in Brazil as the Ministry of Science and Technology, the Development Bank of Minas Gerais; the Center for Strategic Studies and Management; and the Brazilian Industrial Development Agency.

Her major publications and research interests are about Development, Regional economics, Computable General Equilibrium modeling, Public Policies impacts and Taxation. She has presented research papers at various local and international conferences and serves as referee to various academic journals.

ALEX MEERAUS / THOMAS RUTHERFORD TRAVEL FUNDS

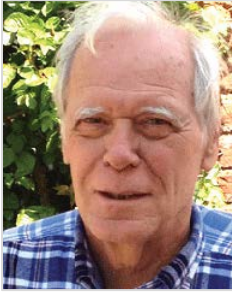

Alexander Meeraus is the founder and CEO Emeritus of GAMS Development Corp., a high-tech international development and consulting firm in the area of strategic and operation planning systems and software applied to problems in industry, government and academia. After finishing his studies in mechanical engineering at the Technical University in Vienna, Austria, he came to the US, worked for General Electric in the development of engineering software for computer aided design and joined the World Bank's Development Research Center in 1972. His research at the Bank focused at investment planning in the process industries, agriculture and water resources. He led the development team for the General Algebraic Modeling System (GAMS), now widely used around the world for strategic and operational planning and scheduling. In 1987, he left the Bank to fully develop the GAMS software into a commercially viable product. In 1988 he was awarded the INFORMS Computing Society Price for the development of GAMS. In the Celebrating 50 Years of Operations Research festschrift, GAMS was selected as the 1988 milestone. In 2012, GAMS shared the INFORMS Impact Price for the development of Algebraic Modeling Systems.

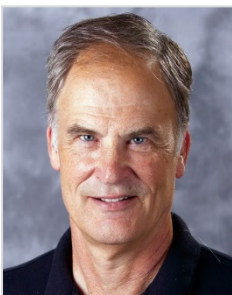

Thomas Rutherford received his Ph.D. in operations research from Stanford University in 1987 and is currently a Professor of Agricultural and Applied Economics at the University of Wisconsin-Madison. Rutherford has had a career arc that has touched the most challenging global policy issues of our times—trade, energy markets, and climate change. He has combined his keen interest in economic policy making while advancing the frontiers of economic modeling in spatial, industrial, mathematical and dynamic economics. Another component of Tom's portfolio is the development of algorithms and software that has led to major improvements in quantitative tools that facilitate the ability to undertake policy analysis. The best known of these tools is the Mathematical Programming System for General Equilibrium (MPSGE), a modeling environment designed to facilitate the development of GE models that is combined with the General Algebraic Modeling System (GAMS). He developed a global model in MPSGE coupled to the GTAP Data Base (known as GTAPinGAMS) that has been widely disseminated and lowered the entry cost to global economic modeling for GAMS users. Over the years, many modelers have been able to share in his discoveries and insights as he has made many of his models and related tools, largely developed in MPSGE and GAMS, available for public use—such as the GTAPinGAMS model, but also overlapping generations models, the use of mixed complementarity such as in the implementation of tariff rate quotas (TRQs), recursive versus intertemporal dynamic models and many others.

Funding Details

In recognition of the contributions made by Alex Meeraus and Thomas Rutherford, the **GAMS Development Corporation** has graciously provided travel reimbursement funding in their names aimed to support the participation of promising young researchers at the GTAP Conference and encourage their contribution to the use and further development of analytical software for CGE modelling. Recipient(s) were selected based on being the following criteria.

- an early career researcher within five years of the start of their research career
- active in undertaking applied model-based analyses using GAMS or related software
- paper accepted into the GTAP Conference



ANNUAL CONFERENCE ON GLOBAL ECONOMIC ANALYSIS
ALEX MEERAUS / THOMAS RUTHERFORD TRAVEL FUNDS

Recipients

The GAMS Development Corporation and the Center for Global Trade Analysis, Purdue University are pleased to announce the following recipients of the 2018 Alex Meeraus / Thomas Rutherford Travel Funds.

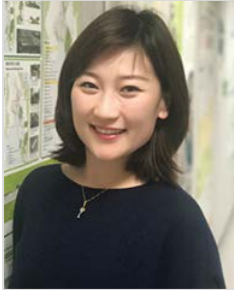

Yue (Bonnie) Wang

Post-doctoral Fellow, Department of Urban Planning and Design, The University of Hong Kong

Endogenous carbon price in New Zealand: A forest-CGE analysis

by Wang, Yue (Bonnie), Basil Sharp, John Kim and Stephen Poletti
(Session #5, pg. 16)

Dr. Yue Wang holds a Ph.D. in economics from the University of Auckland in New Zealand, and joined the Department of Urban Planning and Design at the University of Hong Kong in October 2017. Her research interests are in the area of Computable General Equilibrium (CGE) modelling and application, economic policy analysis, climate change, as well as environmental sustainability. Her current research project is investigating the regional growth and distribution impacts of improved cross-border inland transport system in the China-Indochina Peninsula economic corridor under China's "One Belt, One Road" (OBOR) policy, based on the development of a dynamic multi-region, multi-sector CGE model.



Rayan Wolf

Phd Student, Federal University of Viçosa

EFFECTS OF THE BOLSA FAMÍLIA PROGRAM ON ECONOMIC WELL-BEING OF FAMILIES IN BRAZILIAN MACROREGIONS: A COMPUTABLE GENERAL EQUILIBRIUM ANALYSIS

by Wolf, Rayan, Erly Cardoso Teixeira, Matheus Wemerson Gomes Pereira, Angelo Costa Gurgel and Leandro Tamio Marques Higano
(Session #26, pg. 29)

Rayan Wolf graduated in Economics Sciences at Federal University of Mato Grosso do Sul, holds a Master's degree in Organization and Society Management from the Federal University of Mato Grosso do Sul, and is currently a PhD Student in Applied Economics at Federal University of Viçosa, as well as being a PhD Scholarship holder from CNPq. He is a researcher on public policies and social programs; a PAEG researcher and data contributor (General Equilibrium Analysis Project for the Brazilian Economy); and has been researching mathematical methods in economics, mainly focusing on computable general equilibrium models.

CONFERENCE VENUES

Locations / Distances	Cartagena de Indias Convention Center (Main venue)	Teatro Adolfo Mejía (Thursday Plenary)	Universidad de Cartagena San Agustín Campus (Thursday Reception)
Cartagena de Indias Convention Center Cl. 24 #8A-344 Cartagena, Colombia	-	1.0 km 15 minute walk	750 m 10 minute walk
Teatro Adolfo Mejía Cr 4 # De La Merced, Cra. 10 #3638 Cartagena, Colombia	1.0 km 15 minute walk	-	300 m 5 minute walk
Universidad de Cartagena San Agustín Campus Cra. 6 #36-100 Cartagena, Colombia	750 m 10 minute walk	300 m 5 minute walk	-

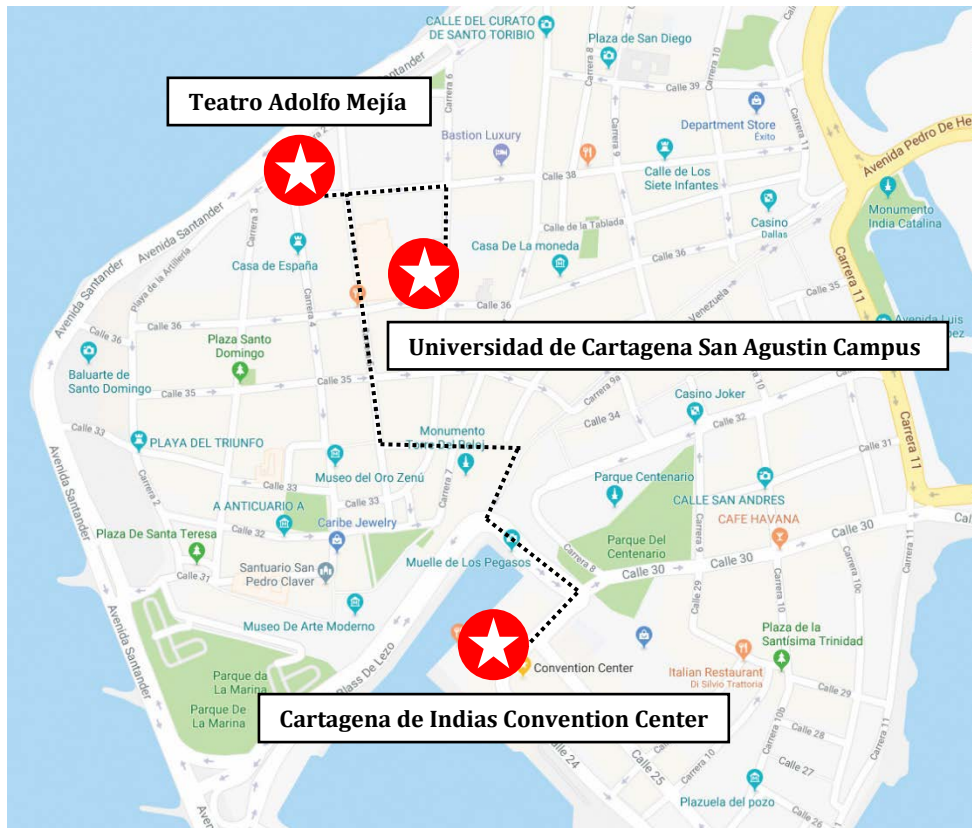

Walking Directions

Convention Center to Teatro Adolfo Mejía (1km, 15mins)

1. Head northeast on Calle 24 toward Calle 25 (120m)
2. Turn left onto Avenida Calle 24 Real/Calle 29 (180m)
3. Sharp right onto Calle 32/Avenida Venezuela (62m)
4. Keep left to stay on Calle 32/Av. Venezuela (45m)
5. Turn left onto Calle 34 (190m)
6. Turn right onto Carrera 5 (350m)
7. Turn left onto Calle 38 (Destination on the right)

Teatro Adolfo Mejía to Univ de Cartagena (300m, 5 mins)

1. Head east on Calle 38 toward Carrera 5 (190m)
2. Turn right onto Carrera 6 (Destination on the right)

CONFERENCE VENUES

Convention Center WiFi

Network Name: GTAP
 Password: GTAP2018

Convention Center Floor Plans

Level 1

- Entrance
- Coffee Breaks – Claustro de las Animas
- Lunches – Claustro de las Animas
- Wednesday Reception – Terraza del Claustro

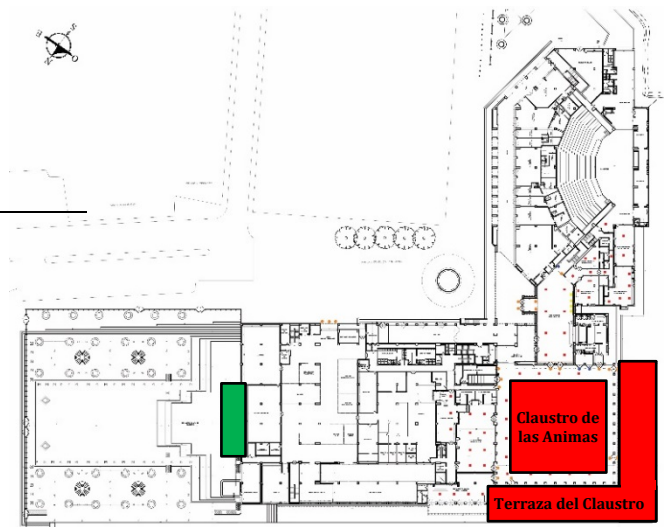

Level 2

- Registration Desk – Portico Explanada
- Plenary Sessions – Barahona 2

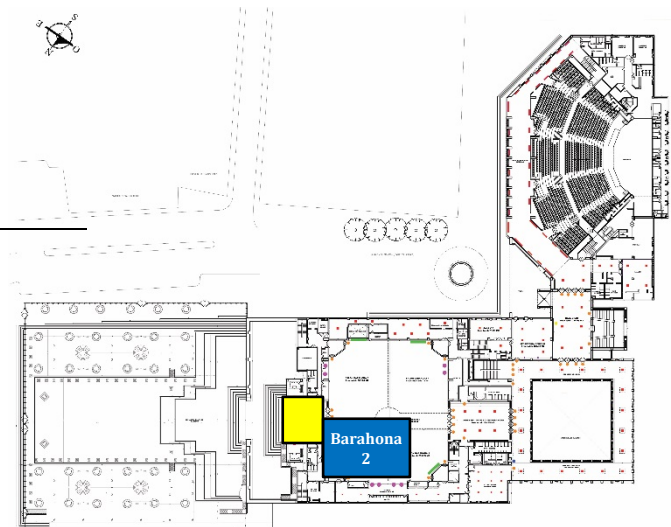

Level 3

- Parallel Sessions – 301, 302A, 302B, 303A, 303B, 304A, 304B

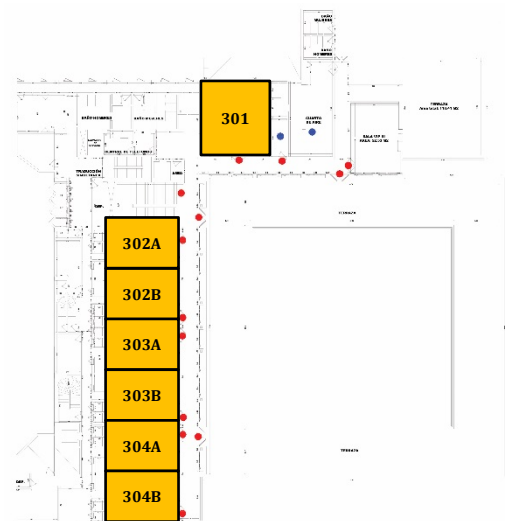

WEDNESDAY, JUNE 13**Session Overview**

Session details for this day are listed on pages 14-24. You can also access the conference schedule through the **Whova** mobile app. See page 3 for details.

	Barahona 2 (Level 2)	301 (Level 3)	302A (Level 3)	302B (Level 3)	303A (Level 3)	303B (Level 3)	304A (Level 3)	304B (Level 3)
8:30-9:00am	Opening Ceremony <i>Pg. 14</i>							
9:00-10:00am	Plenary Session <i>Trading off the Income Gains and the Inequality Costs of Trade Policy</i> <i>Pg. 14</i>							
10:30am-12:30pm		*Session #1 <i>Changes in Energy Consumption and Production</i> <i>Pg. 14</i>	*Session #2 <i>Modelling global supply chains and government procurement: Implications for trade policy</i> <i>Pg. 15</i>	*Session #3 <i>Structural change in labor markets and time use – case studies from Africa, Asia, and Latin America</i> <i>Pg. 15</i>	Session #4 <i>Brexit Impacts</i> <i>Pg. 16</i>	Session #5 <i>Land Use</i> <i>Pg. 16</i>	Session #6 <i>Water</i> <i>Pg. 17</i>	Session #7 <i>Climate Policy and Impacts</i> <i>Pg. 17</i>
2:00-4:00pm (14:00-16:00)		*Session #8 <i>Student Session - Climate Change Mitigation and Impacts</i> <i>Pg. 18</i>	*Session #9 <i>New Advances in Data & Modelling of Non-Tariff Measures</i> <i>Pg. 19</i>	*Session #10 <i>The Continental Free Trade Area and African challenges</i> <i>Pg. 19</i>	Session #11 <i>Bioenergy and Emissions</i> <i>Pg. 20</i>	Session #12 <i>Agricultural Policies</i> <i>Pg. 20</i>	Session #13 <i>Dynamic Modelling</i> <i>Pg. 21</i>	Session #14 <i>Land Use, Transportation, Electricity, and Demographics</i> <i>Pg. 21</i>
4:30-6:30pm (16:30-18:30)		*Session #15 <i>Projecting the future: Practices and guidelines</i> <i>Pg. 22</i>	*Session #16 <i>Institutional Change and Spatially-Specific Policies to Facilitate Sustainable Development</i> <i>Pg. 22</i>	*Session #17 <i>CGE analyses of FDI flows</i> <i>Pg. 23</i>	Session #18 <i>Global Value and Supply Chains</i> <i>Pg. 23</i>	Session #19 <i>Labor Market Issues</i> <i>Pg. 24</i>	Session #20 <i>Climate and Agriculture (Brazil)</i> <i>Pg. 24</i>	

*Organized Session

WEDNESDAY, JUNE 13

Distinguished Plenary Speaker

“Trading off the Income Gains and the Inequality Costs of Trade Policy”



Guido Porto

Professor of Economics
Universidad Nacional de La Plata
<https://sites.google.com/site/guidoportounlp/>

Guido Gustavo Porto is a Professor of Economics at Universidad Nacional de La Plata (UNLP) in Argentina. He obtained his Ph.D. in Economics from Princeton University in 2002. Professor Porto's research interest are international trade and economic development. He has studied how trade reforms affect poverty and household welfare, especially in developing and low-income countries. He also investigates how households, farmers and firms adjust to trade reforms and trade shocks. He has published extensively on these topics in leading professional journals.

WEDNESDAY, JUNE 13**Presentation Schedule**

Presenters (in bold) should arrive 10 minutes prior to the start of their session with their presentation on a USB drive in both PowerPoint and PDF formats. Unless otherwise noted, all parallel session presentations are allotted 30 minutes - 20 for presentation, immediately followed by 10 for discussion.

**Looking for a paper?**

Search by ID# at: www.gtap.agecon.purdue.edu/events/conferences/2018/

Time	Event	Location
8:00am-5:00pm (8:00-17:00)	Onsite Registration	Portico Explanada (Level 2)
8:30-9:00am	Opening Ceremony	Barahona 2 (Level 2)
	<ul style="list-style-type: none"> – Opening Remarks by Thomas Hertel and Dominique van der Mensbrugghe Center for Global Trade Analysis, Department of Agricultural Economics, Purdue University 	
9:00-10:00am	Plenary Session	Barahona 2 (Level 2)
	<p>Chair: Carmen Estrades</p> <ul style="list-style-type: none"> – Trading off the Income Gains and the Inequality Costs of Trade Policy by Porto, Guido 	
10:00-10:30am	Coffee Break	Claustro de las Animas (Level 1)
10:30am-12:30pm	Organized Session #1	301 (Level 3)

“Changes in Energy Consumption and Production”

Organizer: Andre Barbe

Chair: Saad Ahmad

- **The General Equilibrium Effects of Environmental Regulations in the Electricity Generation** (#5604)
by Antonio, Katherine M. and **Badri Narayanan**
- **A Computable General Equilibrium Analysis of Expanded Use of Alternative Fuel Vehicles** (#5592)
by **Cai, Yongxia**, Katherine M. Antonio, Robert Beach and Jeffrey Petrusa
- **Economic Impacts of Bioelectricity from Forest Biomass when Forest Producers have Comparative Advantage: the case of Brazil** (#5593)
by Alves, Gabriel and **Angelo Gurgel**
- **Validating GTAP-E using the Shale Revolution** (#5527)
by **Barbe, Andre**

WEDNESDAY, JUNE 13**Presentation Schedule**

Presenters (in bold) should arrive 10 minutes prior to the start of their session with their presentation on a USB drive in both PowerPoint and PDF formats. Unless otherwise noted, all parallel session presentations are allotted 30 minutes - 20 for presentation, immediately followed by 10 for discussion.

**Looking for a paper?**

Search by ID# at: www.gtap.agecon.purdue.edu/events/conferences/2018/

Time	Event	Location
10:30am-12:30pm	Organized Session #2	302A (Level 3)

“Modelling global supply chains and government procurement: Implications for trade policy”

Organizers: Lucian Cernat and Zornitsa Kutlina-Dimitrova

Chair: Lucian Cernat

- **The economic effects of a GPA plus agreement: The impact of BRICS (#5463)**
by **Kutlina-Dimitrova, Zornitsa**
- **How to enhance the participation of LDCs in global supply chains: A Global Supply Proposal for a multilateral preferential scheme (GSP++) (#5498)**
by **Antimiani, Alessandro** and Lucian Cernat
- **Value-added in a Computable General Equilibrium model with oligopolistic competition: drivers and implications of sourcing by agent in the MIRAGE-e model (#5526)**
by **Bellora, Cecilia** and Jean Fouré

10:30am-12:30pm	Organized Session #3	302B (Level 3)
-----------------	----------------------	-------------------

“Structural change in labor markets and time use – case studies from Africa, Asia, and Latin America”

Organizer: Hans Lofgren

Chair/Discussant: Sherman Robinson

- **Development Strategy, Agri-food System Transformation, and Job Creation: Prospects for the ‘Planting for Food and Jobs’ Initiative in Ghana (#5629)**
by **Pauw, Karl**, Gracie Rosenbach and James Thurlow
- **Time Use and the Care Economy in Latin America: A General Equilibrium Analysis (#5546)**
by **Cicowiez, Martin**
- **Care in an Aging East Asian Economy: Policy options and impacts on households and labor markets (#5624)**
by **Lofgren, Hans**, Marzia Fontana and Kijong Kim

WEDNESDAY, JUNE 13**Presentation Schedule**

Presenters (in bold) should arrive 10 minutes prior to the start of their session with their presentation on a USB drive in both PowerPoint and PDF formats. Unless otherwise noted, all parallel session presentations are allotted 30 minutes - 20 for presentation, immediately followed by 10 for discussion.

**Looking for a paper?**

Search by ID# at: www.gtap.agecon.purdue.edu/events/conferences/2018/

Time	Event	Location
10:30am-12:30pm	Session #4	303A (Level 3)
	<p>"Brexit Impacts" Chair: Maria C. Latorre</p> <ul style="list-style-type: none"> - <u>Brexit consequences for the United Kingdom: The role of multinationals</u> (#5533) by Ortiz Valverde, Gabriela - <u>Ireland and the Brexit: What are the Impacts for the Irish Agri-Food Sectors?</u> (#5605) by Boysen, Ole, Kirsten Boysen-Urban and Corina Miller - <u>Will Br-exit lead to Afr-exit? General Equilibrium Analysis</u> (#5631) by Osman, Rehab O. M. 	
10:30am-12:30pm	Session #5	303B (Level 3)

"Land Use"

Chair: Erwin Corong

- **Modeling land use in large scale global computable general equilibrium models: Preserving physical area of land** (#5634)
by **Taheripour, Farzad**, Xin Zhao and Wally Tyner
- **Estimation of parameters for the SIMPLE model using a maximum entropy approach** (#5613)
by **McClain, Verena** and Thomas Hertel
- **Endogenous carbon price in New Zealand: A forest-CGE analysis** (#5486)
by **Wang, Yue (Bonnie)**, Basil Sharp, John Kim and Stephen Poletti
**Alex Meeraus / Thomas Rutherford Travel Funds Recipient*

WEDNESDAY, JUNE 13**Presentation Schedule**

Presenters (in bold) should arrive 10 minutes prior to the start of their session with their presentation on a USB drive in both PowerPoint and PDF formats. Unless otherwise noted, all parallel session presentations are allotted 30 minutes - 20 for presentation, immediately followed by 10 for discussion.

**Looking for a paper?**

Search by ID# at: www.gtap.agecon.purdue.edu/events/conferences/2018/

Time	Event	Location
10:30am-12:30pm	Session #6	304A (Level 3)
	<p>"Water" Chair: Jing Liu</p> <ul style="list-style-type: none"> - <u>Economy-wide impact of changing water availability in Senegal: an application of the JRC.DEMETRA CGE model (#5513)</u> by Sartori, Martina, Hasan Dudu, Emanuele Ferrari and Alfredo Mainar - <u>Water pricing under climate uncertainty - an economy-wide model considering precipitation stochastics (#5548)</u> by Luckmann, Jonas and Davit Stepanyan - <u>The Impacts of Climate Change on Surface and Ground Water Withdrawal: A New Global Data Base of Costs and Returns of Irrigation (#5589)</u> by Haqiqi, Iman and Marziyeh Bahalou Horeh 	
10:30am-12:30pm	Session #7	304B (Level 3)
	<p>"Climate Policy and Impacts" Chair: Jonathan Pycroft</p> <ul style="list-style-type: none"> - <u>Boon or Bane? Trade Sanctions and the Stability of International Environmental Agreements (#5643)</u> by Hagen, Achim and Jan Schneider - <u>Economic and environmental implications of a target for bioplastics consumption: A CGE analysis (#5524)</u> by Escobar, Neus, Salwa Haddad and Wolfgang Britz - <u>Climate policy implications from Nationally Determined Contributions to Deep Decarbonization Transformations in the EU (#5530)</u> by Parrado, Ramiro - <u>The Impact of China's Carbon Trading Scheme (#5579)</u> by He, Jianwu and Shantong Li 	
12:30-2:00pm (12:30-14:00)	Lunch	Claustro de las Animas (Level 1)

WEDNESDAY, JUNE 13**Presentation Schedule**

Presenters (in bold) should arrive 10 minutes prior to the start of their session with their presentation on a USB drive in both PowerPoint and PDF formats. Unless otherwise noted, all parallel session presentations are allotted 30 minutes - 20 for presentation, immediately followed by 10 for discussion.

**Looking for a paper?**

Search by ID# at: www.gtap.agecon.purdue.edu/events/conferences/2018/

Time	Event	Location
2:00-4:00pm (14:00-16:00)	Organized Session #8	301 (Level 3)

“Student Session - Climate Change Mitigation and Impacts”

Organizer/Chair: Mary Burfisher

Presentations in this session are allotted 15 minutes – 10 for presentation, immediately followed by 5 for discussion.

- **Climate finance under a CGE framework: decoupling financial flows in GTAP database (#5523)**
by **Garaffa, Rafael**, Bruno Cunha, Angelo Gurgel, Andre Lucena, Alexandre Szklo, Roberto Schaeffer and Pedro Rochedo
- **Global Climate Change Mitigation: Unilateral and Strategic Incentive (#5536)**
by **Perdana, Sigit** and Rod Tyers
- **Economic Analysis of Climatic and Agricultural Impacts of Nuclear War (#5563)**
by Hochman, Gal, **Hainan Zhang**, Alan Robock, Lili Xia, Dominique van der Mensbrugge and Saketh Aleti
- **The Economic Case for Renewable Energy: a Recursive Dynamic Model Analysis for the Nicaraguan Economy (#5555)**
by **Cortes Selva, Alma**
- **Value transportation’s air-quality co-benefits from climate mitigation (#5622)**
by Cai, Yongxia, Robert Beach, **Katherine M. Antonio** and Badri Narayanan
- **The Effects for Brazil of Linking Emissions Trading Schemes in the context of the Heterogeneity of Trading Partners (#5547)**
by **Oliveira, Thais**, Angelo Gurgel and Steve Tonry
- **Evaluation of the socio economic impacts in Ecuador due to refinery matrix change using a General Equilibrium Model (#5470)**
by **Castro, Pedro**, Christian Graßmann and Marcelo Cunha
- **Economic and regional impacts of investments in electricity generation in Brazil (#5512)**
by **Diniz, Tiago**, Joaquim Bento Ferreira-Filho and Mark Horridge

WEDNESDAY, JUNE 13**Presentation Schedule**

Presenters (in bold) should arrive 10 minutes prior to the start of their session with their presentation on a USB drive in both PowerPoint and PDF formats. Unless otherwise noted, all parallel session presentations are allotted 30 minutes - 20 for presentation, immediately followed by 10 for discussion.

**Looking for a paper?**

Search by ID# at: www.gtap.agecon.purdue.edu/events/conferences/2018/

Time	Event	Location
2:00-4:00pm (14:00-16:00)	Organized Session #9	302A (Level 3)
	<p><i>"New Advances in Data and Modelling of Non-Tariff Measures"</i> Organizers: Terrie Walmsley and Anna Strutt Chair: Ralf Peters</p> <ul style="list-style-type: none"> - <u>Non-Tariff Measures and Regional Integration in ASEAN (#5490)</u> by Vanzetti, David, Christian Knebel and Ralf Peters - <u>Modelling the Harmonizing of Non-Tariff Measures: An application to Goods Trade in the Trans-Pacific Partnership Region (#5561)</u> by Strutt, Anna, Christian Knebel, Ralf Peters and Terrie Walmsley - <u>New Approaches to Modelling Non-Tariff Measures (#5516)</u> by Walmsley, Terrie and Anna Strutt 	
2:00-4:00pm (14:00-16:00)	Organized Session #10	302B (Level 3)
	<p><i>"The Continental Free Trade Area and African challenges"</i> Organizers: Stephen Karingi and Mustapha Sadni Jallab Chair/Discussant: Maarten Smeets</p> <ul style="list-style-type: none"> - <u>A Positive Agenda for African Economies: Assessment of the African Continental Free Trade Area Modalities (#5599)</u> by Mevel, Simon and Stephen Karingi 	

WEDNESDAY, JUNE 13**Presentation Schedule**

Presenters (in bold) should arrive 10 minutes prior to the start of their session with their presentation on a USB drive in both PowerPoint and PDF formats. Unless otherwise noted, all parallel session presentations are allotted 30 minutes - 20 for presentation, immediately followed by 10 for discussion.

**Looking for a paper?**

Search by ID# at: www.gtap.agecon.purdue.edu/events/conferences/2018/

Time	Event	Location
2:00-4:00pm (14:00-16:00)	Session #11	303A (Level 3)
<i>"Bioenergy and Emissions"</i>		
Chair: Niven Winchester		
<ul style="list-style-type: none"> - <u>Can the evolution of the European bioeconomy contribute to the Sustainable Development Goals? (#5528)</u> by Philippidis, George, Lindsay Shutes, Hans van Meijl, Robert M'barek, Tevecia Ronzon and Saeed Moghayer - <u>The Land and Water Implications of Biomass Co-Firing in the MISO region (#5568)</u> by Sun, Shanxia, Thomas Hertel, Brayam Valqui, Mort Webster and Jing Liu - <u>What would the US economy and emissions look like without shale gas (#5552)</u> by Chen, Y.-H. Henry, John Reilly and Sergey Paltsev - <u>Lowering CO2 emissions in the Swiss transport sector (#5485)</u> by Thalmann, Philippe and Marc Vielle 		
2:00-4:00pm (14:00-16:00)	Session #12	303B (Level 3)

"Agricultural Policies"

Chair: Wusheng Yu

- **Modelling domestic and international impacts of China's grain policy reform scenarios since 2014: a comparison of two modelling approaches (#5544)**
by **Yu, Wusheng** and Shingo Kimura
- **U.S. county-level impacts of growth in China's demand for agricultural imports (#5591)**
by Cheng, Yichuan and **Russell Hillberry**
- **Colombia's Agricultural Land Conversion, Expansion, and Policies (#5632)**
by **Valdes, Constanza** and Kim Hjort

WEDNESDAY, JUNE 13**Presentation Schedule**

Presenters (in bold) should arrive 10 minutes prior to the start of their session with their presentation on a USB drive in both PowerPoint and PDF formats. Unless otherwise noted, all parallel session presentations are allotted 30 minutes - 20 for presentation, immediately followed by 10 for discussion.

**Looking for a paper?**

Search by ID# at: www.gtap.agecon.purdue.edu/events/conferences/2018/

Time	Event	Location
2:00-4:00pm (14:00-16:00)	Session #13	304A (Level 3)
	<p><i>"Dynamic Modelling"</i> Chair: Ken Itakura</p> <ul style="list-style-type: none"> - <u>The Dynamics of Asset Ownership (#5454)</u> by Kennedy, Tom - <u>A Gdyn model with USAGE-type Investment Function and Labor Market Mechanism (#5617)</u> by Xiao, Jingliang and Erwin Corong 	
2:00-4:00pm (14:00-16:00)	Session #14	304B (Level 3)
	<p><i>"Land Use, Transportation, Electricity, and Demographics"</i> Chair: Edson Domingues</p> <ul style="list-style-type: none"> - <u>AGLINK-COSIMO: Economic Impact on Agriculture of a Low Carbon Economy (#5525)</u> by Jensen, Hans Grinsted - <u>A spatial general equilibrium analysis of transport policies in Sydney, Australia (#5628)</u> by Lennox, James and Janine Dixon - <u>Disaggregating the electricity sector in a CGE model to allow competition theory to explain the introduction of new technologies to the sector (#5550)</u> by Truong, Truong and Hiroshi Hamasaki - <u>Estimating LES Parameters with Heterogeneous Households for a CGE Model (#5489)</u> by Gharibnavaz, Mohammad Reza and George Verikios 	
4:00-4:30pm (16:00-16:30)	Coffee Break	Claustro de las Animas (Level 1)

WEDNESDAY, JUNE 13**Presentation Schedule**

Presenters (in bold) should arrive 10 minutes prior to the start of their session with their presentation on a USB drive in both PowerPoint and PDF formats. Unless otherwise noted, all parallel session presentations are allotted 30 minutes - 20 for presentation, immediately followed by 10 for discussion.

**Looking for a paper?**

Search by ID# at: www.gtap.agecon.purdue.edu/events/conferences/2018/

Time	Event	Location
4:30-6:30pm (16:30-18:30)	Organized Session #15	301 (Level 3)
<p><i>“Projecting the future: Practices and guidelines”</i> Organizers: Rob Dellink, Bert Saveyn, and Dominique van der Mensbrugge Chair: Dominique van der Mensbrugge</p> <ul style="list-style-type: none"> - <u>Macroeconomic drivers of baseline scenarios in dynamic CGE models: review and guidelines proposal</u> (#5641) by Fouré, Jean, Angel Aguiar, Ruben Bibas, Jean Chateau, Shinichiro Fujimori, Marian Leimbach, Luis Rey-los-Santos and Hugo Valin - <u>Calibrating Supply-side driven structural changes in CGE baseline</u> (#5642) by Chateau, Jean, Erwin Corong, Jean Fouré, Elisa Lanzi and Roberto Roson - <u>Trade in dynamic CGE models. Theoretical structure, projections, and challenges</u> (#5646) by Bekkers, Eddy, Lionel Fontagné, William Powers, Alessandro Antimiani, Dorothee Flaig, Joseph Francois, Ken Itakura, Zornitsa Kutlina-Dimitrova, Bert Saveyn and Frank van Tongeren 		
4:30-6:30pm (16:30-18:30)	Organized Session #16	302A (Level 3)
<p><i>“Institutional Change and Spatially-Specific Policies to Facilitate Sustainable Development”</i> Organizer/Chair: Jing Liu</p> <ul style="list-style-type: none"> - <u>Global economic and food security impacts of demand-driven water scarcity</u> (#5510) by Nechifor, Victor - <u>Research on the interaction of energy-water nexus considering spatial heterogeneity</u> (#5479) by Xia, Yan - <u>Using Targeted Policies to Manage Nitrogen for Sustainable Agriculture in the US</u> (#5475) by Liu, Jing, Thomas Hertel, Christopher Kucharik, Uris Lantz Baldos, Jarvis Larrisa and Navin Ramankutty 		

WEDNESDAY, JUNE 13**Presentation Schedule**

Presenters (in bold) should arrive 10 minutes prior to the start of their session with their presentation on a USB drive in both PowerPoint and PDF formats. Unless otherwise noted, all parallel session presentations are allotted 30 minutes - 20 for presentation, immediately followed by 10 for discussion.

**Looking for a paper?**

Search by ID# at: www.gtap.agecon.purdue.edu/events/conferences/2018/

Time	Event	Location
4:30-6:30pm (16:30-18:30)	Organized Session #17	302B (Level 3)
	<p><i>"CGE analyses of FDI flows"</i> Organizer: Marinos Tsigas Chair: Andre Barbe Discussant: Zornitsa Kutlina-Dimitrova</p> <ul style="list-style-type: none"> - <u>Networks of Foreign Services Affiliates: Evidence from Japanese Micro-Data</u> (#5514) by Spinelli, Francesca, Dorothée Rouzet and Hongyong Zhang - <u>An Economic Analysis of U.S. FDI in China and Mexico: A GTAP-FDI Model Perspective</u> (#5596) by Yuan, Wen and Marinos Tsigas - <u>Export, Horizontal FDI, or Export Platform FDI with Heterogeneous Firms</u> (#5556) by Oyamada, Kazuhiko 	
4:30-6:30pm (16:30-18:30)	Session #18	303A (Level 3)
	<p><i>"Global Value and Supply Chains"</i> Chair: Peter Bailey</p> <ul style="list-style-type: none"> - <u>Unraveling the economic performance of the CEEC countries. The role of exports and global value chains.</u> (#5487) by Hagemejer, Jan and Muck Jakub - <u>HOW IMPORTANT ARE TRADE POLICIES FOR BACKWARD AND FORWARD PARTICIPATION OF THE SUB-SAHARAN AFRICA COUNTRIES IN AGRICULTURE AND FOOD GLOBAL VALUE CHAINS?</u> (#5572) by Balié, Jean, Ilaria Fusacchia and Luca Salvatici - <u>Global Supply Chains: towards a CGE analysis</u> (#5504) by Rimmer, Maureen, Premachandra Athukorala and Peter Dixon 	

WEDNESDAY, JUNE 13**Presentation Schedule**

Presenters (in bold) should arrive 10 minutes prior to the start of their session with their presentation on a USB drive in both PowerPoint and PDF formats. Unless otherwise noted, all parallel session presentations are allotted 30 minutes - 20 for presentation, immediately followed by 10 for discussion.

**Looking for a paper?**

Search by ID# at: www.gtap.agecon.purdue.edu/events/conferences/2018/

Time	Event	Location
4:30-6:30pm (16:30-18:30)	Session #19	303B (Level 3)
	<p><i>"Labor Market Issues"</i> Chair: Andres Escobar</p> <ul style="list-style-type: none"> - <u>Unemployment meets a mobility function to model cross-border movements of labor between Palestine and Israel</u> (#5461) by Agbahey, Johanes, Khalid Siddig and Harald Grethe - <u>Implications of Refugee Influx on Demographics, Labor Market, and Welfare</u> (#5567) by Yakut, Aykut Mert - <u>Innovation and Employment</u> (#5474) by Peluffo, Adriana and Ernesto Silva 	
4:30-6:30pm (16:30-18:30)	Session #20	304A (Level 3)
	<p><i>"Climate and Agriculture (Brazil)"</i> Chair: Erly Teixeira</p> <ul style="list-style-type: none"> - <u>BRAZILIAN AGRICULTURE AND LIVESTOCK: REGIONAL PERFORMANCE AND TECHNOLOGICAL DETERMINERS OF PRODUCTIVITY IN THE CENSUS YEARS OF 1995/96 AND 2006</u> (#5483) by Felema, João and Humberto F.S. Spolador - <u>Regional Impacts of Future Climate Change on Health and Labor in Brazil</u> (#5571) by R. Guedes, Gilvan, Kenya Noronha, Sara Curran, Aline Magalhaes, Edson Domingues, Mônica Viegas, Kenia Souza, Flaviane Santiago, Débora Cardoso and Jarvis Campos - <u>Demographic Changes and its Impacts on Consumption and Greenhouse Gas Emissions in Brazil: a computable general equilibrium model approach</u> (#5578) by Sabadini Carvalho, Terciane, Flaviane Santiago and Fernando Perobelli - <u>Greening the Brazilian energy grid as a sustainable response to increasing consumption: how feasible and how costly?</u> (#5573) by Magalhaes, Aline, Gilvan Guedes, Edson Domingues and Sara Curran 	
6:30pm (18:30)	Reception	Terrazas de Claustro (Level 1)

THURSDAY, JUNE 14**Session Overview**

Session details for this day are listed on pages 27-37. You can also access the conference schedule through the **Whova** mobile app. See page 3 for details.

	Teatro Adolfo Mejía	301 (Level 3)	302A (Level 3)	302B (Level 3)	303A (Level 3)	303B (Level 3)	304A (Level 3)	304B (Level 3)
9:00-11:00am		*Session #21 <i>Trade projections</i> Pg. 27	*Session #22 <i>Assessing the Trade and Growth Impacts of the Belt and Road Initiative</i> Pg. 27	*Session #23 <i>China's Economic Trends and its Impact</i> Pg. 28	Session #24 <i>Brexit and EU Trade Agreements</i> Pg. 28	Session #25 <i>Climate Impacts on Agriculture</i> Pg. 28	Session #26 <i>Poverty Analysis (Brazil and Southern Africa)</i> Pg. 29	
11:30am-1:30pm (11:30-13:30)		*Session #27 <i>Student Session - Trade, Food, and Poverty</i> Pg. 30	*Session #28 <i>Modelling African migration with CGE models: from urbanization to international migration</i> Pg. 31	*Session #29 <i>Regional and global climate policies</i> Pg. 31	Session #30 <i>Land Use (Brazil)</i> Pg. 32	Session #31 <i>Climate Impacts on Wildlife and Agriculture</i> Pg. 32	Session #32 <i>Trade Impacts and Trade in Services</i> Pg. 33	Session #33 <i>Healthcare and Welfare Reform and Population Demographics</i> Pg. 33
3:00-4:30pm (15:00-16:30)		*Session #34 <i>International Trade in Services Statistics: Latest Developments to Improve Data for Economic Modelling</i> Pg. 34	*Session #35 <i>Analyzing trade using new approaches in CGE modeling and parameterization</i> Pg. 34	*Session #36 <i>Modelling the circular economy: current state of the art and future developments</i> Pg. 35	Session #37 <i>The Paris Agreement</i> Pg. 35	Session #38 <i>Food Demand and Security</i> Pg. 35	Session #39 <i>Economic Growth and Impacts (Asia-Pacific)</i> Pg. 36	Session #40 <i>Africa</i> Pg. 36
5:15-6:15pm (17:15-18:15)	Plenary Session <i>How did natural resource exporters manage the recent commodity price cycle? Lessons from Latin America</i> Pg. 36							

*Organized Session

THURSDAY, JUNE 14

Distinguished Plenary Speaker

***“How did natural resource exporters manage the recent commodity price cycle?
Lessons from Latin America”***



Guillermo Perry

Professor
Universidad de los Andes, Facultad de Economía
<https://economia.uniandes.edu.co/profesores/visitantes>

Guillermo Perry is presently a Professor at the School of Economics at Universidad de Los Andes in Colombia and a Non Resident Fellow at the Center for Global Development, Washington DC. He was formerly the Chief Economist for Latin America and the Caribbean at the World Bank from 1996 to 2007, Minister of Finance and Public Credit (1994/96) and of Mining and Energy (1986/88) and Member of the Constitutional assembly of 1991 in his home country, Colombia. He was also Director of Colombia’s two leading economic think-tanks, FEDESARROLLO and the Center for Economic Development Studies (CEDE), a Visiting Fellow at St Anthony’s College at Oxford University (1977/78) and Robert F. Kennedy Visiting Professor at the MPA-ID program in the Kennedy School at Harvard University (2010/11).

He is or has been a member of various Boards and Advisory Committees, such as: the Global Development Network (GDN) Governing Body, the Latin American Advisory Committee of the Woodrow Wilson Institute, the Executive Committee of the Latin American and Caribbean Economics Association (LACEA) and the Board of Directors of FEDESARROLLO, Universidad de Los Andes, Financiera de Desarrollo Nacional, Banco de Bogotá, BAC Credomatic, Ecopetrol, ISA and Empresa de Energía Eléctrica de Bogota, among others. He has also served in several Government appointed Advisory Commissions (Intergovernmental Public Finances - 1983-, Employment -1990-, Capital Markets -1994-, Infrastructure -2012- and Tax Reform -2015-) in Colombia. He has had broad consulting experience around the world in public finances, tax, energy policy and industrial policies, through the previous Harvard Institute for International Development (presently CID), the World Bank, IDB and other institutions.

Mr. Perry attended the Ph.D. program in Economics and Operational Research at the Massachusetts Institute of Technology (1968-1973).

Born in Bogota, Colombia on October 13, 1945, Mr. Perry is married to Claudia Saenz Obregon. He and his wife have two children, Juana and Antonio

THURSDAY, JUNE 14**Presentation Schedule**

Presenters (in bold) should arrive 10 minutes prior to the start of their session with their presentation on a USB drive in both PowerPoint and PDF formats. Unless otherwise noted, all parallel session presentations are allotted 30 minutes - 20 for presentation, immediately followed by 10 for discussion.

**Looking for a paper?**

Search by ID# at: www.gtap.agecon.purdue.edu/events/conferences/2018/

Time	Event	Location
8:00am–4:00pm (8:00-16:00)	Onsite Registration	Portico Explanada (Level 2)
9:00-11:00am	Organized Session #21	301 (Level 3)
<p><i>“Trade projections”</i> Organizer/Chair: Eddy Bekkers</p> <ul style="list-style-type: none"> – <u>G-RDEM: A GTAP-based recursive dynamic CGE model for long-term baseline generation and analysis (#5501)</u> by Roson, Roberto and Wolfgang Britz – <u>CALIBRATING LONG-TERM TRADE BASELINES IN GENERAL EQUILIBRIUM (#5594)</u> by Fouré, Jean and Lionel Fontagné – <u>Achieving a long-run equilibrium in the dynamic GTAP model (#5484)</u> by Gretton, Paul – <u>Long run trends in international trade. The impact of new technologies (#5562)</u> by Bekkers, Eddy, Bob Koopman and Robert Teh 		
9:00-11:00am	Organized Session #22	302A (Level 3)

“Assessing the Trade and Growth Impacts of the Belt and Road Initiative”

Organizer: Maryla Maliszewska

Chair: Michele Ruta

- **TRADE EFFECTS OF THE NEW SILK ROAD (#5635)**
by Baniya, Suprabha, Siobhan Murray, **Nadia Rocha** and Michele Ruta
- **An Economy-wide Analysis of the Belt and Road Initiative (#5626)**
by **Maliszewska, Maryla** and Dominique van der Mensbrugge
- **Trade impact of BRI: a quantitative prospective study (#5535)**
by **De Soyres, François**, Alen Mulabdic and Michele Ruta

THURSDAY, JUNE 14

Presentation Schedule

Presenters (in bold) should arrive 10 minutes prior to the start of their session with their presentation on a USB drive in both PowerPoint and PDF formats. Unless otherwise noted, all parallel session presentations are allotted 30 minutes - 20 for presentation, immediately followed by 10 for discussion.



Looking for a paper?

Search by ID# at: www.gtap.agecon.purdue.edu/events/conferences/2018/

Time	Event	Location
9:00-11:00am	Organized Session #23	302B (Level 3)
	<p><i>"China's Economic Trends and its Impact"</i> Organizer/Chair: Yaxiong Zhang</p> <ul style="list-style-type: none"> - <u>The effects of the full implementation of "Business Tax to VAT" reform in China</u> (#5453) by Songfeng, Cai and Yaxiong Zhang - <u>Assessing the Impact of China-Canada FTA with G-Dyn Model</u> (#5625) by Lyu, Yingkang and Jingliang Xiao 	
9:00-11:00am	Session #24	303A (Level 3)
	<p><i>"Brexit and EU Trade Agreements"</i> Chair: Hildegunn Nordas</p> <ul style="list-style-type: none"> - <u>Losing Preferential Access to Third Countries after Brexit - What is at stake?</u> (#5450) by Freund, Florian, Martin Banse and Janine Pelikan - <u>Brexit and Everything But Arms (EBA) Countries: Loosing Preferences</u> (#5559) by Olekseyuk, Zoryana and Israel Osorio Rodarte - <u>Impacts of EU - Trade Agreements: Which liberalization path is already decided and what can we expect in the future?</u> (#5505) by Pelikan, Janine, Florian Freund and Tatjana Döbeling 	
9:00-11:00am	Session #25	303B (Level 3)
	<p><i>"Climate Impacts on Agriculture"</i> Chair: Andres Escobar</p> <ul style="list-style-type: none"> - <u>CLIMATE CHANGE IMPACTS ON THE COLOMBIAN AGRICULTURAL SECTOR: PRODUCTION AND FOOD PRICES</u> (#5477) by Romero Torres, Bernardo and Andres Escobar - <u>GTAP-EW7 – A model to assess the impacts of climate change on world water availability and usage throughout the agricultural sectors of the world economies</u> (#5570) by Hamasaki, Hiroshi and Truong Truong - <u>Assessing the Impacts of Global Climate Change on Nutrient Availability in Latin America</u> (#5620) by Beach, Robert, Yongxia Cai and Katherine M. Antonio 	

THURSDAY, JUNE 14

Presentation Schedule

Presenters (in bold) should arrive 10 minutes prior to the start of their session with their presentation on a USB drive in both PowerPoint and PDF formats. Unless otherwise noted, all parallel session presentations are allotted 30 minutes - 20 for presentation, immediately followed by 10 for discussion.



Looking for a paper?

Search by ID# at: www.gtap.agecon.purdue.edu/events/conferences/2018/

Time	Event	Location
9:00-11:00am	Session #26	304A (Level 3)
	<p>"Poverty Analysis (Brazil and Southern Africa)" Chair: Martin Cicowiez</p> <ul style="list-style-type: none"> - <u>Structural impacts of a cash transfer program: an application of a SAM based CGE model for Brazil (#5602)</u> by Freire, Debora, Edson Domingues and Gustavo Britto <i>*Ken Pearson Travel Funds Recipient</i> - <u>EFFECTS OF THE BOLSA FAMÍLIA PROGRAM ON ECONOMIC WELL-BEING OF FAMILIES IN BRAZILIAN MACROREGIONS: A COMPUTABLE GENERAL EQUILIBRIUM ANALYSIS (#5482)</u> by Wolf, Rayan, Erly Cardoso Teixeira, Matheus Wemerson Gomes Pereira, Angelo Costa Gurgel and Leandro Tamio Marques Higano <i>*Alex Meeraus / Thomas Rutherford Travel Funds Recipient</i> - <u>Assessing Policy Failure in a General Political Equilibrium Framework: Derivation and application of a new CGPE-approach (#5590)</u> by Henning, Christian, Johannes Hedtrich and Ligane Sene 	
11:00-11:30am	Coffee Break	Claustro de las Animas (Level 1)

THURSDAY, JUNE 14**Presentation Schedule**

Presenters (in bold) should arrive 10 minutes prior to the start of their session with their presentation on a USB drive in both PowerPoint and PDF formats. Unless otherwise noted, all parallel session presentations are allotted 30 minutes - 20 for presentation, immediately followed by 10 for discussion.

**Looking for a paper?**

Search by ID# at: www.gtap.agecon.purdue.edu/events/conferences/2018/

Time	Event	Location
11:30am-1:30pm (11:30-13:30)	Organized Session #27	301 (Level 3)

"Student Session - Trade, Food, and Poverty"

Organizer/Chair: Mary Burfisher

Presentations in this session are allotted 15 minutes - 10 for presentation, immediately followed by 5 for discussion.

- **LATIN AMERICA AND CHINA: Multilateralism or dependency? An approach of Computable General Equilibrium for selected countries** (#5455)
by **Lopes Afonso, Damares**, Suzana Quinet Bastos and Fernando Perobelli
- **Hunger and Obesity: the "double burden" of malnutrition in a SIMPLE framework** (#5515)
by **Lopez Barrera, Emiliano**
- **Free Trade Agreements and import-import substitution effect Evidence from a CGE analysis: the case of EU-Korea and EU-Japan FTAs** (#5518)
by **Porto, Massimiliano**
- **Key Sectors - Key Policies: Challenges on Estimating and Validating a Policy-Impact Function** (#5519)
by **Hedtrich, Johannes**, Christian Aßmann and Christian Henning
- **Applying Meta modeling for extended CGE-modeling: Sample techniques and potential application** (#5538)
by **Jin, Ding**, Johannes Hedtrich and Christian Henning
- **Modeling the emergence of hysteresis in agri-food sectors** (#5553)
by **Cosnard, Lionel**
- **Economic Impact of the United States withdrawal from Trans-Pacific Partnership on Canada: A Computable General Equilibrium Based Analysis** (#5557)
by **Ghaith, Ziad**, David Natcher and Suren Kulshreshtha
- **India-ASEAN Free Trade Agreement and its Impact on India's agriculture sector** (#5595)
by **Miglani, Smita**

THURSDAY, JUNE 14

Presentation Schedule

Presenters (in bold) should arrive 10 minutes prior to the start of their session with their presentation on a USB drive in both PowerPoint and PDF formats. Unless otherwise noted, all parallel session presentations are allotted 30 minutes - 20 for presentation, immediately followed by 10 for discussion.



Looking for a paper?

Search by ID# at: www.gtap.agecon.purdue.edu/events/conferences/2018/

Time	Event	Location
11:30am-1:30pm (11:30-13:30)	Organized Session #28	302A (Level 3)
<p><i>“Modelling African migration with CGE models: from urbanization to international migration”</i> Organizers: Giampiero Genovese and Emanuele Ferrari Chair: Giampiero Genovese</p> <ul style="list-style-type: none"> - <u>Unemployment and Rural-Urban Migration in Ethiopia (#5502)</u> by Boulanger, Pierre H, Hasan Dudu, Emanuele Ferrari, Kidanemariam Hailu, Alfredo Mainar, Mohammed Beshir Mohammed, Alekaw K Yeshineh and Giampiero Genovese - <u>A broader perspective on African migration - adding migration to the climate-food nexus (#5488)</u> by Verma, Monika, Marijke Kuiper, Diti Oudendag, Heleen Bartelings, Lindsay Shutes, John Helming and Hans van Meijl 		
11:30am-1:30pm (11:30-13:30)	Organized Session #29	302B (Level 3)

“Regional and global climate policies”

Organizer/Chair: Maksym Chepeliev

- **The global Paris Agreement: consequences for local outdoor air pollution (#5478)**
 by Saveyn, Bert, Toon Vandyck, Kimon Keramidias, Joseph V. Spadaro, Rita Van Dingenen, Mike Holland, Alban Kitous and **Antonio Soria Ramirez**
- **Global Fossil-fuel Subsidy Reform and Paris Agreement (#5531)**
 by **Chepeliev, Maksym** and Dominique van der Mensbrugge
- **The Economic, Energy, and Emissions Impacts of Climate Policy in South Korea (#5638)**
 by **Winchester, Niven**

THURSDAY, JUNE 14**Presentation Schedule**

Presenters (in bold) should arrive 10 minutes prior to the start of their session with their presentation on a USB drive in both PowerPoint and PDF formats. Unless otherwise noted, all parallel session presentations are allotted 30 minutes - 20 for presentation, immediately followed by 10 for discussion.

**Looking for a paper?**

Search by ID# at: www.gtap.agecon.purdue.edu/events/conferences/2018/

Time	Event	Location
11:30am-1:30pm (11:30-13:30)	Session #30	303A (Level 3)
"Land Use (Brazil)"		
Chair: Joaquim Bento Ferreira-Filho		
<ul style="list-style-type: none"> - <u>A Cost-Benefit Analysis of Securing Indigenous Environmental Management in Brazil</u> (#5569) by Costanti, Elke and Jorge Nogueira - <u>The role of double cropping modeling for policy assessment in Brazil</u> (#5606) by Zanetti De Lima, Cicero and Angelo Gurgel - <u>Potential impacts of changes in the Brazil's New Forest Code on Agriculture, 2010 to 2030: an integrated analysis based on the GLOBIOM-Brazil and TERM-Br</u> (#5585) by Santos, Mari Aparecida dos, Joaquim Bento de Souza Ferreira Filho, José Eustáquio Ribeiro Vieira Filho and Alexandre Xavier de Carvalho Ywata - <u>ENVIRONMENTAL AND WELFARE IMPACTS OF DEFORESTATION REDUCTION IN BRAZIL</u> (#5497) by Ferreira-Filho, Joaquim Bento, Luis Fernando Guedes Pinto, Vinicius Guidotti Faria and Guerd Sparovek 		
11:30am-1:30pm (11:30-13:30)	Session #31	303B (Level 3)
"Climate Impacts on Wildlife and Agriculture"		
Chair: Lucas Ferraz		
<ul style="list-style-type: none"> - <u>Global Trade and Welfare Implications of Climate-Induced Wild Catch Fishery Decline</u> (#5466) by Burkhardt, Jesse, Amanda M. Countryman, Dale Manning, Duy Nong and Travis Warziniack - <u>The Biophysical and Economic Geographies of Global Climate Impacts on Agriculture</u> (#5633) by Baldos, Uris Lantz, Thomas Hertel and Frances Moore - <u>The Crucial Role of International Trade in Adaptation to Climate Change</u> (#5639) by Gouel, Christophe and David Laborde 		

THURSDAY, JUNE 14

Presentation Schedule

Presenters (in bold) should arrive 10 minutes prior to the start of their session with their presentation on a USB drive in both PowerPoint and PDF formats. Unless otherwise noted, all parallel session presentations are allotted 30 minutes - 20 for presentation, immediately followed by 10 for discussion.



Looking for a paper?

Search by ID# at: www.gtap.agecon.purdue.edu/events/conferences/2018/

Time	Event	Location
11:30am-1:30pm (11:30-13:30)	Session #32	304A (Level 3)
	<p><i>"Trade Impacts and Trade in Services"</i> Chair: Lionel Fontagné</p> <ul style="list-style-type: none"> - <u>US Withdrawal From International Trade: Analyzing the Impact on the Global Trading System With a Global CGE Model and a Gravity Model</u> (#5576) by Robinson, Sherman and Karen Thierfelder - <u>Do investment agreements promote foreign investment?</u> (#5558) by Dadkhah, Ali and Dan Ciuriak - <u>On the Duration of Trade in Services: Evidence from Germany</u> (#5603) by Nitsch, Volker 	
11:30am-1:30pm (11:30-13:30)	Session #33	304B (Level 3)
	<p><i>"Healthcare and Welfare Reform and Population Demographics"</i> Chair: Kirsten Boysen-Urban</p> <ul style="list-style-type: none"> - <u>The macroeconomic implications of public healthcare financing: a computable general equilibrium analysis of Uganda</u> (#5542) by Kabajulizi, Judith, Marcus Keogh-Brown and Richard Smith - <u>Excursion in Reality - The Nordic Model Revisited</u> (#5587) by Honkatukia, Juha - <u>Growing old gracefully: fiscal policy for ageing society</u> (#5543) by Álvarez-Martínez, María T., Diego d'Andria, Jason Debacker, Richard Evans, Maria Gesualdo, Jonathan Pycroft, Estefanía Vázquez-Torres and Magdalena Zachlod-Jelec - <u>Sustainable consumption and population dynamics in Brazil</u> (#5601) by Guedes, Gilvan, Edson Domingues, Sueli Mingoti, Kenia Souza, Flaviane Santiago, Aline Magalhaes and Cardoso Cardoso 	
1:30-3:00pm (13:30-15:00)	Lunch	Claustro de las Animas (Level 1)

THURSDAY, JUNE 14

Presentation Schedule

Presenters (in bold) should arrive 10 minutes prior to the start of their session with their presentation on a USB drive in both PowerPoint and PDF formats. Unless otherwise noted, all parallel session presentations are allotted 30 minutes - 20 for presentation, immediately followed by 10 for discussion.



Looking for a paper?

Search by ID# at: www.gtap.agecon.purdue.edu/events/conferences/2018/

Time	Event	Location
3:00-4:30pm (15:00-16:30)	Organized Session #34	301 (Level 3)
<p><i>“International Trade in Services Statistics: Latest Developments to Improve Data for Economic Modelling”</i> Organizer/Chair: Andreas Maurer</p> <ul style="list-style-type: none"> – <u>TOWARDS A GLOBAL DATA SET ON TRADE IN SERVICES BY SECTOR AND MODE OF SUPPLY – A PROGRESS REPORT (#5494)</u> by Wettstein, Steen, Lucian Cernat, Andreas Maurer, Antonella Liberatore and Barbara D'Andrea – <u>BEA INITIATIVES TO IMPROVE AND INTERPRET ITS STATISTICS ON TRADE IN SERVICES AND GLOBAL PRODUCTION (#5511)</u> by Fetzer, James – <u>Services Trade Policy, Evidence from a World Bank-WTO Database (#5537)</u> by Borchert, Ingo, Batshur Gootiiz, Joscelyn Magdeleine, Juan Marchetti and Aaditya Mattoo 		
3:00-4:30pm (15:00-16:30)	Organized Session #35	302A (Level 3)
<p><i>“Analyzing trade using new approaches in CGE modeling and parameterization”</i> Organizers: Saad Ahmad and Zeynep Akgul Chair: Saad Ahmad</p> <ul style="list-style-type: none"> – <u>Aggregating CES elasticities for CGE models (#5491)</u> by Horridge, Mark – <u>Using Power Laws to Identify the Structural Parameters of Trade Models with Firm Heterogeneity (#5610)</u> by Ahmad, Saad and Zeynep Akgul – <u>Converting GTAP from Armington to Melitz: giving Melitz sectors to GTAP (#5503)</u> by Dixon, Peter, Michael Jerie and Maureen Rimmer 		

THURSDAY, JUNE 14

Presentation Schedule

Presenters (in bold) should arrive 10 minutes prior to the start of their session with their presentation on a USB drive in both PowerPoint and PDF formats. Unless otherwise noted, all parallel session presentations are allotted 30 minutes - 20 for presentation, immediately followed by 10 for discussion.



Looking for a paper?

Search by ID# at: www.gtap.agecon.purdue.edu/events/conferences/2018/

Time	Event	Location
3:00-4:30pm (15:00-16:30)	Organized Session #36	302B (Level 3)
<p><i>“Modelling the circular economy: current state of the art and future developments”</i> Organizers: Jean Chateau and Alvaro Calzadilla Chair: Jean Chateau</p> <ul style="list-style-type: none"> – <u>Structural change and changes in materials use: a baseline analysis</u> (#5539) by Bibas, Ruben, Jean Chateau, Rob Dellink and Elisa Lanzi – <u>Modelling the potential saturation levels of iron and steel in China: wider economic impacts and circular economy implications</u> (#5459) by Winning, Matthew, Alvaro Calzadilla, Victor Nechifor and Raimund Bleischwitz 		
3:00-4:30pm (15:00-16:30)	Session #37	303A (Level 3)
<p><i>“The Paris Agreement”</i> Chair: Sergey Paltsev</p> <ul style="list-style-type: none"> – <u>The Paris agreement without US Lessons from an integrated assessment exercise in a second best modeling framework</u> (#5522) by Hamdi-Cherif, Meriem – <u>Analysis on Indirect Influences of the U.S. Withdrawal from the Paris Agreement on China’s Coal Production and Carbon Emissions of Surrounding Nations</u> (#5521) by Kato, Nozomi and Ken Itakura – <u>Finding itself in the post-Paris world: Russia in the new global energy landscape</u> (#5469) by Makarov, Igor, Y.-H. Henry Chen and Sergey Paltsev 		
3:00-4:30pm (15:00-16:30)	Session #38	303B (Level 3)
<p><i>“Food Demand and Security”</i> Chair: David Vanzetti</p> <ul style="list-style-type: none"> – <u>Will Income or Population be the Main Driver of Food Demand Growth to 2050?</u> (#5618) by Yang, Anton, Christophe Gouel and Thomas Hertel – <u>Are there positive synergies between agricultural export promotion and food security? Evidence from African economies</u> (#5464) by Aragie, Emerta Asaminew, Jean Balie, Scott McDonald, Cristian Morales Opazo and Karl Pauw 		

THURSDAY, JUNE 14

Presentation Schedule

Presenters (in bold) should arrive 10 minutes prior to the start of their session with their presentation on a USB drive in both PowerPoint and PDF formats. Unless otherwise noted, all parallel session presentations are allotted 30 minutes - 20 for presentation, immediately followed by 10 for discussion.



Looking for a paper?

Search by ID# at: www.gtap.agecon.purdue.edu/events/conferences/2018/

Time	Event	Location
3:00-4:30pm (15:00-16:30)	Session #39	304A (Level 3)
	<p><i>"Economic Growth and Impacts (Asia-Pacific)"</i> Chair: Yoko Uchida</p> <ul style="list-style-type: none"> - <u>CGE Simulation of the ASEAN Economic Community and RCEP under Long-term Productivity Scenarios (#5621)</u> by Itakura, Ken - <u>Understanding the relationship between Pacific Alliance and the mega-regional agreements in Asia-Pacific: what we learned from the GTAP simulation (#5575)</u> by Garcia, Jose, Camilo Perez-Restrepo and Maria Teresa Uribe Jaramillo 	
3:00-4:30pm (15:00-16:30)	Session #40	304B (Level 3)
	<p><i>"Africa"</i> Chair: Brian Mureverwi</p> <ul style="list-style-type: none"> - <u>Effects of ICT investment on South Africa's agro-processing industries (#5564)</u> by Lefophane, Mapula Hildah and Mmatlou Kalaba - <u>Estimating Elasticities for Crop Production in Niger using Maximum Entropy (#5534)</u> by Kabir, Kayenat and Thomas Hertel 	
4:30-5:15pm (16:30-17:15)	Transition Time	
	<ul style="list-style-type: none"> - During this time, please make your way to the Teatro Adolfo Mejía for the plenary session, which will begin at 5:15pm. Please see page 10 for the theater's address and walking directions. 	
5:15-6:15pm (17:15-18:15)	Plenary Session	Teatro Adolfo Mejía
	<p>Chair: Angelo Gurgel</p> <ul style="list-style-type: none"> - How did natural resource exporters manage the recent commodity price cycle? Lessons from Latin America by Perry, Guillermo 	

THURSDAY, JUNE 14

Presentation Schedule

Presenters (in bold) should arrive 10 minutes prior to the start of their session with their presentation on a USB drive in both PowerPoint and PDF formats. Unless otherwise noted, all parallel session presentations are allotted 30 minutes - 20 for presentation, immediately followed by 10 for discussion.



Looking for a paper?

Search by ID# at: www.gtap.agecon.purdue.edu/events/conferences/2018/

Time	Event	Location
6:45pm (18:45)	Reception and Awards Ceremony	Univ de Cartagena San Agustin Campus

- Following the plenary session, please make your way to the Universidad de Cartagena, San Agustin Campus for the evening reception. Please see page 10 for the university's address and walking directions.

Awards Ceremony

- Partnering Organization and Sponsor Recognition
- Conference Travel Funds Recipient Recognition
- Alan A. Powell Award
- GTAP Research Fellows
- GTAP Research Fellow Hall of Fame

FRIDAY, JUNE 15
Session Overview

Session details for this day are listed on pages 40-43. You can also access the conference schedule through the **Whova** mobile app. See page 3 for details.

	Barahona 2 (Level 2)	301 (Level 3)	302A (Level 3)	302B (Level 3)	303A (Level 3)	303B (Level 3)	304A (Level 3)
9:00-11:00am		*Session #41 <i>Brexit and related issues</i> <i>Pg. 40</i>	*Session #42 <i>CGE applications for Colombia</i> <i>Pg. 40</i>	*Session #43 <i>Data Base Construction: Inputs & Methods</i> <i>Pg. 41</i>	Session #44 <i>Free Trade Agreements</i> <i>Pg. 41</i>	Session #45 <i>Non-Tariff Barriers</i> <i>Pg. 42</i>	Session #46 <i>Agricultural Policies</i> <i>Pg. 42</i>
11:30am-12:30pm	Plenary Session <i>The Energy Revolution and Developing Countries</i> <i>Pg. 43</i>						
12:30-1:00pm (12:30-13:00)	Closing Ceremony <i>Pg. 43</i>						

*Organized Session

FRIDAY, JUNE 15

Distinguished Plenary Speaker

“The Energy Revolution and Developing Countries.”



Channing Arndt

Director of Environment and Production Technology Division

International Food Policy Research Institute (IFPRI)

<http://www.ifpri.org/profile/channing-arndt>

Channing Arndt has more than 25 years of experience in development economics with seven years combined resident experience in Morocco and Mozambique. He has published more than 70 articles in leading academic journals. His recent books include *Growth and Poverty in sub-Saharan Africa*; *Measuring Poverty and Wellbeing in Developing Countries*; and *The Political Economy of Clean Energy Transitions*. He has substantial research management experience including leadership of interdisciplinary teams and has taken leadership roles in major policy documents such as the design of a carbon tax for the National Treasury of South Africa, the *Economics of Adaptation to Climate Change* for the World Bank, and the Second, Third and Fourth National Poverty Assessments for the Government of Mozambique. He has an established reputation for effectively building institutional capacity in Mozambique, South Africa, Morocco, Vietnam and within the framework of the African Economic Research Consortium. His program of research has focused on agricultural development, poverty alleviation and growth, market integration,

gender and discrimination, the implications of the HIV/AIDS pandemic, technological change, trade policy, aid effectiveness, infrastructure investment, energy, bioenergy, climate variability, and the implications of climate change.

FRIDAY, JUNE 15

Presentation Schedule

Presenters (in bold) should arrive 10 minutes prior to the start of their session with their presentation on a USB drive in both PowerPoint and PDF formats. Unless otherwise noted, all parallel session presentations are allotted 30 minutes - 20 for presentation, immediately followed by 10 for discussion.



Looking for a paper?

Search by ID# at: www.gtap.agecon.purdue.edu/events/conferences/2018/

Time	Event	Location
8:00-11:00am	Onsite Registration	Portico Explanada (Level 2)
9:00-11:00am	Organized Session #41	301 (Level 3)
<p><i>"Brexit and related issues"</i> Organizer: Maria C. Latorre Chair: Michael Ferrantino</p> <ul style="list-style-type: none"> - <u>Services Trade Policy, Structural Change and Labour Market Adjustments</u> (#5549) by Nordas, Hildegunn - <u>Brexit and the future of European trade and FDI agreements</u> (#5499) by Latorre, Maria C., Zoryana Olekseyuk and Hidemichi Yonezawa - <u>Deep Integration and UK-EU Trade Relations</u> (#5500) by Ruta, Michele 		
9:00-11:00am	Organized Session #42	302A (Level 3)

"CGE applications for Colombia"

Organizers: Ricardo Arguello and Jesus Botero
 Chair: Ricardo Arguello

- **Commodity Booms, Human Capital, and Economic Growth. An application to Colombia.** (#5588)
by Giraldo, Iader, Ricardo Arguello, Nataly Herrera and Diana Londoño
- **The Cost of Tariff and Non-tariff Protection in Colombia. A Computable General Equilibrium Exercise.** (#5580)
by Botero, Jesus, Jose Garcia and Manuel Correa Giraldo
- **Fiscal Policy and Inequality in a CGE Model for Colombia** (#5480)
by Correa Giraldo, Manuel and Jesus Botero

FRIDAY, JUNE 15

Presentation Schedule

Presenters (in bold) should arrive 10 minutes prior to the start of their session with their presentation on a USB drive in both PowerPoint and PDF formats. Unless otherwise noted, all parallel session presentations are allotted 30 minutes - 20 for presentation, immediately followed by 10 for discussion.

**Looking for a paper?**

Search by ID# at: www.gtap.agecon.purdue.edu/events/conferences/2018/

Time	Event	Location
9:00-11:00am	Organized Session #43	302B (Level 3)
	<p><i>"Data Base Construction: Inputs and Methods"</i> Organizer: Maksym Chepeliev Chair: Robert McDougall</p> <ul style="list-style-type: none"> - <u>Agricultural Production Targeting in the GTAP Data Base: a Look Ahead (#5529)</u> by Aguiar, Angel and Maksym Chepeliev - <u>GTAP Data Base version 10 with domestic margins (#5609)</u> by Corong, Erwin - <u>Evaluating the Asian International Input-Output Table in comparison with the Three Major Multiregional Input-Output Tables (#5623)</u> by Uchida, Yoko and Kazuhiko Oyamada - <u>A Bayesian methodology for building consistent datasets for structural modeling (#5545)</u> by Mason-D'Croz, Daniel, Sherman Robinson, Shahnika Dunston and Tim Sulser 	
9:00-11:00am	Session #44	303A (Level 3)

"Free Trade Agreements"

Chair: James Fetzer

- **Exempted Sectors in Free Trade Agreements (#5583)**
by Deardorff, Alan and Rishi Sharma
- **Going backwards: Assessing the impact of NAFTA dissolution on Mexico (#5554)**
by Estrades, Carmen
- **Estimating Economic Impacts of the U.S.-South Korea Free Trade Agreement (#5637)**
by Wei, Dan, Zhenhua Chen and Adam Rose
- **The Economic and Distributional Impacts of the TPP and RCEP Free Trade Agreements on the Vietnamese economy (#5582)**
by Osorio Rodarte, Israel

FRIDAY, JUNE 15

Presentation Schedule

Presenters (in bold) should arrive 10 minutes prior to the start of their session with their presentation on a USB drive in both PowerPoint and PDF formats. Unless otherwise noted, all parallel session presentations are allotted 30 minutes - 20 for presentation, immediately followed by 10 for discussion.



Looking for a paper?

Search by ID# at: www.gtap.agecon.purdue.edu/events/conferences/2018/

Time	Event	Location
9:00-11:00am	Session #45	303B (Level 3)
	<p><i>"Non-Tariff Barriers"</i> Chair: Russell Hillberry</p> <ul style="list-style-type: none"> - <u>Economic impact for Central America, Panama and the Dominican Republic (CAPDR) of changes in US trade policy, increased regional integration and new trade agreements (#5493)</u> by Rojas-Romagosa, Hugo and Porfirio Guevara - <u>Comparative Advantages and the Uneven Effects of Non-Tariff Measures (#5619)</u> by Ferraz, Lucas and Marcel Bertini - <u>Modelling the economic impact of the China Belt and Road Initiative on countries in Eastern Africa. (#5653)</u> by Mukwaya, Rodgers and Andrew Mold - <u>Analysis of Trade Facilitation policies on Time to Export and Import (#5541)</u> by Shiferaw, Habtamu and Taiji Hagiwara 	
9:00-11:00am	Session #46	304A (Level 3)
	<p><i>"Agricultural Policies"</i> Chair: Amanda M. Countryman</p> <ul style="list-style-type: none"> - <u>EU Common Agricultural Policy Post-2020: Exploring the Effects of Safety-Net Policy Instruments (#5608)</u> by Boysen-Urban, Kirsten, Ole Boysen, Alan Matthews and Martina Brockmeier - <u>British agriculture and diets inside and outside of the European Union (#5574)</u> by Springmann, Marco and Florian Freund - <u>Impacts of a NoCAP Scenario on Sub-Saharan Africa (#5507)</u> by Boulanger, Pierre H, Hasan Dudu, Emanuele Ferrari, Robert M'barek and George Philippidis 	
11:00-11:30am	Coffee Break	Claustro de las Animas (Level 1)

FRIDAY, JUNE 15
Presentation Schedule

Presenters (in bold) should arrive 10 minutes prior to the start of their session with their presentation on a USB drive in both PowerPoint and PDF formats. Unless otherwise noted, all parallel session presentations are allotted 30 minutes - 20 for presentation, immediately followed by 10 for discussion.



Looking for a paper?

Search by ID# at: www.gtap.agecon.purdue.edu/events/conferences/2018/

Time	Event	Location
11:30am-12:30pm	Plenary Session	Barahona 2 (Level 2)
Chair: Antonio Soria Ramirez		
<ul style="list-style-type: none"> - The Energy Revolution and Developing Countries. by Arndt, Channing 		
12:30-1:00pm (12:30-13:00)	Closing Ceremony	Barahona 2 (Level 2)
<ul style="list-style-type: none"> - 2019 Conference Preview by Jan Hagemejer - Closing Remarks by Dominique van der Mensbrughe 		
1:00-2:30pm (13:00-14:30)	Lunch	Claustro de las Animas (Level 1)

SATURDAY, JUNE 16
Post-Conference Event



Rosario’s Island – Isla del Sol

A day-trip has been arranged for those interested in taking a cruise to the archipelago of the Rosario Islands where guests can enjoy the crystal clear waters of the Colombian Caribbean. Those individuals who registered and paid to participate in this event should make note of the details below.

What to Bring

Casual clothing is acceptable. Temperatures in June can range from morning lows in the mid-70s (24 C) to afternoon highs near 90°F (32 C). Rain is also always a possibility. Participants should also plan to bring sunscreen and a hat, if desired. If participants plan to partake in any additional activities on the island aside from the lunch and aquarium (scuba diving, snorkeling, hiking, canoeing, etc.), appropriate attire should be worn. Additional activities are not included in the price of the trip.

Schedule

Time	Details																												
7:50am	Arrive at Hotel Caribe (Carrera 1 # 2-87, Cartagena) for transportation to La Bodeguita dock. Bus departs hotel promptly at 8:00am. It is strongly recommended that everyone use this transportation to ensure they do not miss the boat.																												
8:30am	Arrive at La Bodeguita dock (Blas De Lezo, Cartagena, Bolívar, Colombia)																												
9:00am	Depart for Rosario Island																												
10:00am-2:30pm (10:00-14:30)	<table border="1"> <thead> <tr> <th colspan="2">Island activities</th> <th><i>Schedule subject to change based on weather.</i></th> <th><i>Approximate prices</i></th> </tr> </thead> <tbody> <tr> <td>Scuba Diving</td> <td>11:00am</td> <td>188,000 COP / 67 USD</td> <td>(cash/credit card)</td> </tr> <tr> <td>Snorkeling or Free Diving</td> <td>11:00am</td> <td>65,000 COP / 23 USD</td> <td>(cash/credit card)</td> </tr> <tr> <td>Ecological hike and canoe trip</td> <td>Throughout day</td> <td>51,000 COP / 18 USD</td> <td>(cash)</td> </tr> <tr> <td>Relaxing Massages</td> <td>Throughout day</td> <td>51,000 COP / 18 USD</td> <td>(cash)</td> </tr> <tr> <td>Aquarium</td> <td>12:00pm</td> <td colspan="2">Included in registration fee</td> </tr> <tr> <td>Lunch</td> <td>1:00pm / 13:00</td> <td colspan="2">Included in registration fee</td> </tr> </tbody> </table>	Island activities		<i>Schedule subject to change based on weather.</i>	<i>Approximate prices</i>	Scuba Diving	11:00am	188,000 COP / 67 USD	(cash/credit card)	Snorkeling or Free Diving	11:00am	65,000 COP / 23 USD	(cash/credit card)	Ecological hike and canoe trip	Throughout day	51,000 COP / 18 USD	(cash)	Relaxing Massages	Throughout day	51,000 COP / 18 USD	(cash)	Aquarium	12:00pm	Included in registration fee		Lunch	1:00pm / 13:00	Included in registration fee	
Island activities		<i>Schedule subject to change based on weather.</i>	<i>Approximate prices</i>																										
Scuba Diving	11:00am	188,000 COP / 67 USD	(cash/credit card)																										
Snorkeling or Free Diving	11:00am	65,000 COP / 23 USD	(cash/credit card)																										
Ecological hike and canoe trip	Throughout day	51,000 COP / 18 USD	(cash)																										
Relaxing Massages	Throughout day	51,000 COP / 18 USD	(cash)																										
Aquarium	12:00pm	Included in registration fee																											
Lunch	1:00pm / 13:00	Included in registration fee																											
3:00pm (15:00)	Depart for mainland																												
4:00pm (16:00)	Arrive at La Bodeguita dock. Buses return participants to the Hotel Caribe. Everyone is responsible for their own transportation after being dropped off at the hotel.																												

ANNUAL CONFERENCE ON GLOBAL ECONOMIC ANALYSIS

PARTICIPANT LIST

Name	Organization	Country	Email
Adams, Philip	Victoria University	Australia	philip.adams@vu.edu.au
Agbahey, Johanes	Humboldt-Universität zu Berlin	Germany	johanes.agbahey@hu-berlin.de
Aguiar, Angel	Center for Global Trade Analysis, Purdue University	United States	aaguiar@purdue.edu
Ahmad, Saad	US International Trade Commission	United States	saad.ahmad@usitc.gov
Ali Boana Hidi, El-Anzize	African Union Commission	Ethiopia	elanzize01@yahoo.fr
Angulo, Grace Angulo	Universidad de Cartagena	Colombia	gangulop@unicartagena.edu.co
Antimiani, Alessandro	Università degli Studi Roma Tre	Italy	alessandro.antimiani@crea.gov.it
Antonio, Katherine M.	University of North Carolina at Greensboro / RTI International	Bolivia	kmacarena@gmail.com
Aragie, Emerta Asaminew	Food And Agricultural Organization (FAO)	Italy	emertas@yahoo.com
Arguello, Ricardo	Universidad del Rosario	Colombia	arguello.ricardo@gmail.com
Arndt, Channing	IFPRI	United States	c.arndt@cgiar.org
Baena, Rosana	Universidad de Cartagena	Colombia	rgonzalezb1@unicartagena.edu.co
Bahalou Horeh, Marziyeh	West Virginia University	United States	mb0062@mix.wvu.edu
Bailey, Peter	New Zealand Ministry of Foreign Affairs and Trade	New Zealand	peter.bailey@mfat.govt.nz
Barbe, Andre	US International Trade Commission	United States	andre.barbe@usitc.gov
Batta, Ginger	Center for Global Trade Analysis, Purdue University	United States	gbatta@purdue.edu
Beach, Robert	RTI International	United States	rbeach@rti.org
Bekkers, Eddy	World Trade Organization	Switzerland	eddybekkers@gmail.com
Bellora, Cecilia	CEPII	France	cecilia.bellora@cepii.fr
Botero, Jesus	Universidad EAFIT	Colombia	jabotero@eafit.edu.co
Boysen, Ole	University College Dublin	Ireland	ole.boysen@ucd.ie
Boysen-Urban, Kirsten	University of Hohenheim	Germany	kirsten.urban@uni-hohenheim.de
Burfisher, Mary	Center for Global Trade Analysis, Purdue University	United States	burfisher@gmail.com
Cai, Yongxia	RTI International	United States	ycai@rti.org
Castro, Pedro	University of Campinas	Brazil	ing.pedrocastro@hotmail.com
Castro, Robinson	Universidad de Cartagena	Colombia	rcastroa@unicartagena.edu.co
Cernat, Lucian	European Commission - DG Trade	Belgium	lucian.cernat@ec.europa.eu
Chateau, Jean	OECD Environment Directorate	France	jean.chateau@oecd.org

ANNUAL CONFERENCE ON GLOBAL ECONOMIC ANALYSIS

PARTICIPANT LIST

Name	Organization	Country	Email
Chen, Shenjie	Global Affairs Canada	Canada	shenjie.chen@international.gc.ca
Chen, Y.-H. Henry	MIT Joint Program on the Science and Policy of Global Change	United States	chenyh@mit.edu
Chepeliev, Maksym	Center for Global Trade Analysis, Purdue University	United States	mchepeli@purdue.edu
Cicowiez, Martin	CEDLAS-Universidad Nacional de La Plata	Argentina	martin@depeco.econo.unlp.edu.ar
Corong, Erwin	Center for Global Trade Analysis, Purdue University	United States	ecorong@purdue.edu
Correa Giraldo, Manuel	Universidad EAFIT	Colombia	mcorre33@eafit.edu.co
Cortes Selva, Alma	Center for Global Trade Analysis, Purdue University	United States	acortess@purdue.edu
Cosnard, Lionel	GREThA, UMR CNRS-Université de Bordeaux	France	lionel.cosnard@u-bordeaux.fr
Costanti, Elke	University of Brasilia	Brazil	e.costanti@terra.com.br
Countryman, Amanda	Colorado State University	United States	amanda.countryman@colostate.edu
Dadkhah, Ali	Ciuriak Consulting	Canada	Ali@Dadkhah.ca
De Soyres, François	The World Bank	United States	fdesoyres@worldbank.org
Deardorff, Alan	University of Michigan	United States	alandear@umich.edu
Delzeit, Ruth	Kiel Institute for the World Economy	Germany	ruth.delzeit@ifw-kiel.de
Diniz, Tiago	ESALQ/USP	Brazil	tiagotbd@gmail.com
Dixon, Peter	Victoria University	Australia	peter.dixon@vu.edu.au
Domingues, Edson	FACE and Cedeplar - UFMG	Brazil	epdomin@cedeplar.ufmg.br
Doria, Magnolia	Universidad de Cartagena	Colombia	mdoriaa@unicartagena.edu.co
Escobar, Andres	Universidad de Cartagena, Campus Piedra de Bolívar	Colombia	aescobare@unicartagena.edu.co
Escobar, Neus	Institute for Food and Resource Economics (ILR) - University of Bonn	Spain	neus.escobar@ilr.uni-bonn.de
Estrades, Carmen	Department of Economics, Universidad de la Republica	Uruguay	carmen.estrades@gmail.com
Felema, João	ESALQ - USP	Brazil	joafelema@usp.br
Ferrantino, Michael	The World Bank	United States	mferrantino@worldbank.org
Ferrari, Emanuele	European Commission - Joint Research Centre (JRC)	Spain	emanuele.ferrari@ec.europa.eu
Ferraz, Lucas	São Paulo School of Economics - Getulio Vargas Foundation	Brazil	lucas.ferraz@fgv.br
Ferreira-Filho, Joaquim Bento	Escola Superior de Agricultura Luiz de Queiroz	Brazil	jbsferre@usp.br
Fetzer, James	Bureau of Economic Analysis	United States	James.Fetzer@bea.gov
Fontagné, Lionel	Paris School of Economics, Université Paris 1 / CEPII	France	lionel.fontagne@univ-paris1.fr

ANNUAL CONFERENCE ON GLOBAL ECONOMIC ANALYSIS

PARTICIPANT LIST

Name	Organization	Country	Email
Fouré, Jean	Centre d'Etudes Prospectives et d'Information Internationales (CEPII)	France	jean.foure@cepii.fr
Freire, Debora	Federal University of Minas Gerais, Economics Department	Brazil	dfreire@cedeplar.ufmg.br
Freund, Florian	Thünen Institute of Market Analysis	Germany	florian.freund@thuenen.de
Fusacchia, Ilaria	University of Roma Tre	Italy	ilaria.fusacchia@uniroma3.it
Garaffa, Rafael	PPE COPPE UFRJ	Brasil	rgaraffa@ppe.ufrj.br
Garcia, Jose	EAFIT University / University of Huelva	Colombia	jgarc85@eafit.edu.co
Genovese, Giampiero	European Commission - Joint Research Centre	Spain	giampiero.genovese@ec.europa.eu
Ghaith, Ziad	University of Saskatchewan	Canada	zmg170@mail.usask.ca
Gharibnavaz, Reza	KPMG Australia	Australia	rgharibnavaz@kpmg.com.au
Graziano, Paola Graziano	Universidad de Cartagena	Colombia	pgraziano@unicartagena.edu.co
Gretton, Paul	ANU	Australia	gretton.paul@gmail.com
Gurgel, Angelo	Fundacao Getulio Vargas - FGV	Brazil	angelo_gurgel@yahoo.com.br
Hagemejer, Jan	University of Warsaw and National Bank of Poland	Poland	j.hagemejer@uw.edu.pl
Hamasaki, Hiroshi	Fujitsu Research Institute	Japan	hiroshi.keitai@gmail.com
Hamdi-Cherif, Meriem	CIRED	France	hcmeriem@centre-cired.fr
He, Jianwu	Development Reseach Center of State Council	China	jianwu@drc.gov.cn
Hedtrich, Johannes	University of Kiel	Germany	johannes.hedtrich@ae.uni-kiel.de
Henning, Christian	University of Kiel	Germany	chenning@ae.uni-kiel.de
Hertel, Thomas	Center for Global Trade Analysis, Purdue University	United States	hertel@purdue.edu
Hillberry, Russell	Department of Agricultural Economics, Purdue University	United States	rhillber@purdue.edu
Honkatukia, Juha	National Institute for Health and Welfare	Finland	juha.honkatukia@thl.fi
Horridge, Mark	Centre of Policy Studies, Victoria University	Australia	mark.horridge@gmail.com
Hosoe, Nobuhiro	National Graduate Institute for Policy Studies	Japan	nhosoe@grips.ac.jp
Itakura, Ken	Nagoya City University	Japan	itakura@econ.nagoya-cu.ac.jp
Jensen, Hans Grinsted	European Commission, Joint Research Centre (JRC) D4	Spain	Hans.JENSEN@ec.europa.eu
Jerie, Michael	GEMPACK	Australia	michael.jerie@vu.edu.au
Jin, Ding	Christian-Albrechts-Universität zu Kiel	Germany	jinding.merlin@gmail.com
Kabajulizi, Judith	Coventry University, UK	United Kingdom	ac5175@coventry.ac.uk

ANNUAL CONFERENCE ON GLOBAL ECONOMIC ANALYSIS

PARTICIPANT LIST

Name	Organization	Country	Email
Kabir, Kayenat	Center for Global Trade Analysis, Purdue University	United States	kkabir@purdue.edu
Karingi, Stephen	United Nations Economic Commission for Africa (UNECA)	Ethiopia	Skaringi@uneca.org
Kato, Nozomi	Oregon State University	United States	nozomi_ok@hotmail.com
Kennedy, Tom	Self	United States	t7k3s7k9@aol.com
Knebel, Christian	UNCTAD	Switzerland	christian.knebel@unctad.org
Kuiper, Marijke	Wageningen Economic Research	The Netherlands	Marijke.Kuiper@wur.nl
Kutlina-Dimitrova, Zornitsa	European Commission, Directorate-General for TRADE	Belgium	zornitsa.kutlina-dimitrova@ec.europa.eu
Laborde, David	International Food Policy Research Institute (IFPRI)	United States	d.laborde@cgiar.org
Lakatos, Csilla Lakatos	The World Bank	United States	clakatos1@worldbank.org
Latorre, María C.	Universidad Complutense de Madrid,	Spain	cmlatorre@estad.ucm.es
Lefophane, Hildah	University of Pretoria	South Africa	hildajie@gmail.com
Lennox, James	Centre of Policy Studies	Australia	james.lennox@vu.edu.au
Liu, Jing	Center for Global Trade Analysis, Purdue University	United States	liu207@purdue.edu
Lofgren, Hans	Independent Consultant	United States	hanslofgren01@outlook.com
Lopes Afonso, Damares	Federal University of Juiz de Fora	Brazil	damaresalopes@gmail.com
Lopez Barrera, Emiliano	Purdue University	United States	wlopezba@purdue.edu
Luckmann, Jonas	Humboldt Universität zu Berlin	Germany	luckmann@hu-berlin.de
Lyu, Yingkang	China Agricultural University/University of Washington	United States	lyk122511@hotmail.com
Magalhaes, Aline	Federal University of Minas Gerais - Brazil	Brazil	alinesmagalhaes@hotmail.com
Magdeleine, Joscelyn	World Trade Organization	Switzerland	joscelyn.magdeleine@wto.org
Maliszewska, Maryla	The World Bank	United States	mmaliszewska@worldbank.org
Mason-D'Croze, Daniel	Commonwealth Science and Industry Research Organisation	Australia	mail@terraefirmae.com
Maurer, Andreas	WTO	Switzerland	andreas.maurer@wto.org
McClain, Verena	Center for Global Trade Analysis, Purdue University	United States	vmeckle@purdue.edu
McDougall, Robert	Center for Global Trade Analysis, Purdue University	United States	rmcdougall@purdue.edu
McFarland, Jim	U.S. EPA	United States	mcfarland.james@epa.gov
Mercado, Menis	Universidad de Cartagena	Colombia	mmercado2@unicartagena.edu.co
Mevel, Simon	United Nations Economic Commission for Africa	Ethiopia	smevel@uneca.org

ANNUAL CONFERENCE ON GLOBAL ECONOMIC ANALYSIS

PARTICIPANT LIST

Name	Organization	Country	Email
Miglani, Smita	Jawaharlal Nehru University	India	smita.miglani@gmail.com
Milot, Catherine	DFAIT	Canada	catherine.milot@international.gc.ca
Mimouni, Mondher	International Trade Centre (ITC)	Switzerland	mimouni@intracen.org
Moghayer, Saeed	Wageningen Economic Research/Wageningen University & Research	The Netherlands	saeed.moghayer@wur.nl
Mold, Andrew	United Nations Economic Commission for Africa	Rwanda	amold@uneca.org
Montero Mestre, Jorge Luis	Universidad de Cartagena	Colombia	jorgelmm0809@gmail.com
Mureverwi, Brian	African Union Commission	Ethiopia	brianmureverwi@gmail.com
Mustakinov, Dean	Centre of Policy Studies, Victoria University	Australia	dean.mustakinov@vu.edu.au
Narayanan, Badri	Uni Washington, Seattle; Infinite Sum Modelling Inc.; McKinsey & Co.	United States	badrig@uw.edu
Nechifor, Victor	UCL Institute for Sustainable Resources	United Kingdom	victor.nechifor.13@ucl.ac.uk
Nitsch, Volker	TU Darmstadt	Germany	nitsch@vwl.tu-darmstadt.de
Nordas, Hildegunn	OECD	France	hildegunn.nordas@oecd.org
Olekseyuk, Zoryana	German Development Institute	Germany	zoryana.olekseyuk@die-gdi.de
Oliveira, Thais	Institute of Technology Sligo	Ireland	thaisdiniz_oliveira@yahoo.com.br
Ortiz Valverde, Gabriela	Universidad Complutense de Madrid	Spain	gabriela.ortiz.valverde@una.cr
Osman, Rehab O. M.	Faculty of Business, Oxford Brookes University	United Kingdom	rosman@brookes.ac.uk
Osorio Rodarte, Israel	The World Bank	United States	iosoriorodarte@worldbank.org
Oyamada, Kazuhiko	Institute of Developing Economies, Japan External Trade Organization	Japan	kazuhiko_oyamada@ide.go.jp
Paltsev, Sergey	MIT Joint Program on the Science and Policy of Global Change	United States	paltsev@mit.edu
Parrado, Ramiro	CMCC	Italy	ramiro.parrado@cmcc.it
Pauw, Karl	International Food Policy Research Institute (IFPRI)	Ghana	k.pauw@cgiar.org
Pelikan, Janine	Thünen Institute of Market Analysis	Germany	janine.pelikan@thuenen.de
Peluffo, Adriana	Institute of Economics (IECON), University of the Republic	Uruguay	adriana.peluffo@gmail.com
Perdana, Sigit	University of Western Australia	Australia	sigit.perdana@research.uwa.edu.au
Perry, Guillermo	Universidad de los Andes	Colombia	gperry@uniandes.edu.co
Peters, Ralf	United Nations Conference on Trade and Development (UNCTAD)	Switzerland	ralf.peters@unctad.org
Philippidis, George	CITA, Government of Aragón	Spain	gphilippidis@aragon.es
Porto, Guido	Universidad Nacional de La Plata	Argentina	guido.g.porto@gmail.com

ANNUAL CONFERENCE ON GLOBAL ECONOMIC ANALYSIS

PARTICIPANT LIST

Name	Organization	Country	Email
Porto, Massimiliano	Kobe University	Japan	massimiliano.porto@stu.kobe-u.ac.jp
Powers, William	U.S. International Trade Commission	United States	william.powers@usitc.gov
Pycroft, Jonathan	Institute of Prospective Technological Studies	Spain	Jonathan.Pycroft@ec.europa.eu
Rasmussen, Chris	US Department of Commerce	United States	chris.rasmussen@trade.gov
Rimmer, Maureen	Centre of Policy Studies	Australia	maureen.bleazby@vu.edu.au
Robinson, Sherman	International Food Policy Research Institute (IFPRI)	United States	S.Robinson@cgiar.org
Rocha, Nadia	Trade and Competitiveness Unit, World Bank	United States	nrocha@worldbank.org
Rojas-Romagosa, Hugo	CPB Netherlands Bureau for Economic Policy Analysis	The Netherlands	romagosa17@gmail.com
Romero Torres, Bernardo	Universidad de Cartagena	Colombia	bromerot@unicartagena.edu.co
Roos, Louise	Centre of Policy Studies	Australia	Louise.Roos@vu.edu.au
Rose, Adam	University of Southern California	United States	adam.rose@usc.edu
Rosenbach, Gracie	IFPRI	United States	g.rosenbach@cgiar.org
Roson, Roberto	Ca' Foscari University	Italy	roson@unive.it
Ruta, Michele	World Bank	United States	mruta@worldbank.org
Sabadini Carvalho, Terciane	Federal University of Parana	Brazil	tersabadini@gmail.com
Santos, Mari Aparecida dos	Escola Superior de Agricultura	Brazil	mari.economia@gmail.com
Sartori, Martina	Joint Research Centre of the European Commission	Spain	martina.sartori@ec.europa.eu
Schiffmann, Florian	Victoria University	Australia	florian.schiffmann@vu.edu.au
Schneider, Jan	University of Oldenburg	Germany	jan.schneider@uni-oldenburg.de
Shiferaw, Habtamu	Kobe university	Japan	habtamushiferaw@stu.kobe-u.ac.jp
Smeets, Maarten	World Trade Organization	Switzerland	maarten.smeets@wto.org
Songfeng, Cai	State Information Center	China	caisongfeng@126.com
Soria Ramirez, Antonio	European Commission	Spain	antonio.soria@ec.europa.eu
Soroka, Natalie	International Trade Administration	United States	natalie.soroka@trade.gov
Souza, Kenia	UFPR	Brazil	keniadesouza@gmail.com
Spinelli, Francesca	OECD	France	francesca.spinelli@oecd.org
Springmann, Marco	University of Oxford	United Kingdom	marco.springmann@dph.ox.ac.uk
Strutt, Anna	University of Waikato	New Zealand	astrutt@waikato.ac.nz

ANNUAL CONFERENCE ON GLOBAL ECONOMIC ANALYSIS

PARTICIPANT LIST

Name	Organization	Country	Email
Sun, Shanzia	Shanghai University	China	sun217@purdue.edu
Taheripour, Farzad	Department of Agricultural Economics, Purdue University	United States	tfarzad@purdue.edu
Teixeira, Erly	Universidade Federal de Viçosa	Brazil	teixeira@ufv.br
Truong, Truong	Institute of Transport and Logistics Studies	Australia	truong.truong@sydney.edu.au
Uchida, Yoko	Institute of Developing Economies	Japan	uchida@ide.go.jp
Ulloa, Andres	Universidad Catolica de la Santisima Concepcion	Chile	aulloa@ucsc.cl
Valdes, Constanza	USDA Economic Research Service (ERS)	United States	cvaldes@ers.usda.gov
van der Mensbrugge, Dominique	Center for Global Trade Analysis, Purdue University	United States	vandermd@purdue.edu
Vanzetti, David	Australian National University	Australia	david.vanzetti@anu.edu.au
Vielle, Marc	EPFL	Switzerland	marc.vielle@epfl.ch
Walmsley, Terrie	ImpactECON	United States	twalmsley@ImpactECON.com
Wang, Yue (Bonnie)	The University of Hong Kong	Hong Kong	ywan86@hku.hk
Wettstein, Steen	WTO	Switzerland	steen.wettstein@gmail.com
Winchester, Niven	Massachusetts Institute of Technology	United States	niven@mit.edu
Winning, Matthew	UCL Energy Institute	United Kingdom	m.winning@ucl.ac.uk
Wolf, Rayan	Federal University of Viçosa	Brazil	rayanwolf@gmail.com
Xia, Yan	Institute of Policy and Management, CAS	China	xiayan@casipm.ac.cn
Xiao, Charles	Infinite-Sum Modeling Inc. / Ciuriak Consulting Inc.	China	charles.jl.xiao@gmail.com
Xu, Yingying	International Trade Administration	United States	yyxuprivate@gmail.com
Yakut, Aykut Mert	The Economic and Social Research Institute	Ireland	mertyakut@gmail.com
Yang, Anton	Center for Global Trade Analysis, Purdue University	United States	yang1069@purdue.edu
Yu, Wusheng	University of Copenhagen	Denmark	wusheng@ifro.ku.dk
Yuan, Jean	U.S. International Trade Commission	United States	wen.yuan@usitc.gov
Zanetti De Lima, Cicero	Center for Global Trade Analysis, Purdue University	United States	lima1@purdue.edu
Zhang, Hainan	Rutgers University	United States	hz275@scarletmail.rutgers.edu
Zhang, Yaxiong	State Information Center	China	zhangyx@mx.cei.gov.cn

SESSION PARTICIPANT INDEX

Participants should locate their name below to determine the page(s) and subsequent session(s) in which they are scheduled.

A

Agbahey, Johanes	24
Aguiar, Angel.....	41
Ahmad, Saad.....	14, 34
Akgul, Zeynep	34
Antimiani, Alessandro	15
Antonio, Katherine M.....	18
Aragie, Emerta Asaminew	35
Arguello, Ricardo.....	40
Arndt, Channing.....	43

B

Bahalou Horeh, Marziyeh.....	17
Bailey, Peter.....	23
Barbe, Andre	14, 23
Beach, Robert.....	28
Bekkers, Eddy	27
Bellora, Cecilia.....	15
Botero, Jesus.....	40
Boysen, Ole.....	16
Boysen-Urban, Kirsten	33, 42
Burfisher, Mary	18, 30

C

Cai, Yongxia.....	14
Calzadilla, Alvaro.....	35
Castro, Pedro.....	18
Cernat, Lucian.....	15
Chateau, Jean.....	22, 35
Chen, Y.-H. Henry	20
Chepeliev, Maksym	31, 41
Cicowicz, Martin.....	15, 29
Corong, Erwin.....	16, 41
Correa Giraldo, Manuel.....	40
Cortes Selva, Alma.....	18
Cosnard, Lionel	30
Costanti, Elke	32
Countryman, Amanda M.....	32, 42

D

Dadkhah, Ali	33
De Soyres, François.....	27
Deardorff, Alan.....	41
Diniz, Tiago	18
Dixon, Peter	34
Domingues, Edson.....	21, 33

E

Escobar, Andres.....	24, 28
Escobar, Neus.....	17
Estrades, Carmen	14, 41

F

Felema, João.....	24
Ferrantino, Michael.....	40
Ferrari, Emanuele.....	31, 42
Ferraz, Lucas	32, 42
Ferreira-Filho, Joaquim Bento.....	32
Fetzer, James.....	34, 41
Fontagné, Lionel.....	27, 33
Fouré, Jean.....	22
Freire, Debora.....	29
Freund, Florian.....	28
Fusacchia, Ilaria	23

G

Garaffa, Rafael.....	18
Garcia, Jose	36
Genovese, Giampiero.....	31
Ghaith, Ziad	30
Gharibnavaz, Mohammad Reza.....	21
Gretton, Paul.....	27
Gurgel, Angelo	14, 36

H

Hagemeyer, Jan	23, 43
Hamasaki, Hiroshi	28
Hamdi-Cherif, Meriem	35
He, Jianwu.....	17
Hedtrich, Johannes	30
Henning, Christian.....	29
Hertel, Thomas.....	14, 32
Hillberry, Russell.....	20, 42
Honkatukia, Juha	33
Horridge, Mark.....	34

I

Itakura, Ken	21, 36
--------------------	--------

J

Jensen, Hans Grinsted.....	21
----------------------------	----

ANNUAL CONFERENCE ON GLOBAL ECONOMIC ANALYSIS

Jin, Ding.....30

K

Kabajulizi, Judith.....33
 Kabir, Kayenat.....36
 Karingi, Stephen.....19
 Kato, Nozomi.....35
 Kennedy, Tom.....21
 Kuiper, Marijke.....31
 Kutlina-Dimitrova, Zornitsa..... 15, 23

L

Laborde, David.....32
 Latorre, Maria C..... 16, 40
 Lefophane, Mapula Hildah.....36
 Lennox, James.....21
 Liu, Jing..... 17, 22
 Lofgren, Hans.....15
 Lopes Afonso, Damares.....30
 Lopez Barrera, Emiliano.....30
 Luckmann, Jonas.....17
 Lyu, Yingkang.....28

M

Magalhaes, Aline.....24
 Magdeleine, Joscelyn.....34
 Maliszewska, Maryla.....27
 Mason-D'Croz, Daniel.....41
 Maurer, Andreas.....34
 McClain, Verena.....16
 McDougall, Robert.....41
 Mevel, Simon.....19
 Miglani, Smita.....30
 Moghayer, Saeed.....20
 Mold, Andrew.....42
 Mureverwi, Brian.....36

N

Narayanan, Badri.....14
 Nechifor, Victor.....22
 Nitsch, Volker.....33
 Nordas, Hildegunn..... 28, 40

O

Olekseyuk, Zoryana.....28
 Oliveira, Thais.....18
 Ortiz Valverde, Gabriela.....16
 Osman, Rehab O. M.....16
 Osorio Rodarte, Israel.....41
 Oyamada, Kazuhiko.....23

P

Paltsev, Sergey.....35
 Parrado, Ramiro.....17
 Pauw, Karl.....15
 Pelikan, Janine.....28
 Peluffo, Adriana.....24
 Perdana, Sigit.....18
 Perry, Guillermo.....36
 Peters, Ralf.....19
 Porto, Guido.....14
 Porto, Massimiliano.....30
 Powers, William.....22
 Pycroft, Jonathan..... 17, 33

R

Rimmer, Maureen.....23
 Robinson, Sherman..... 15, 33
 Rocha, Nadia.....27
 Rojas-Romagosa, Hugo.....42
 Romero Torres, Bernardo.....28
 Rose, Adam.....41
 Roson, Roberto.....27
 Ruta, Michele..... 27, 40

S

Sabadini Carvalho, Terciane.....24
 Sadni Jallab, Mustapha.....19
 Santos, Mari Aparecida dos.....32
 Sartori, Martina.....17
 Schneider, Jan.....17
 Shiferaw, Habtamu.....42
 Smeets, Maarten.....19
 Songfeng, Cai.....28
 Soria Ramirez, Antonio..... 31, 43
 Souza, Kenia.....24
 Spinelli, Francesca.....23
 Springmann, Marco.....42
 Strutt, Anna.....19
 Sun, Shanxia.....20

T

Taheripour, Farzad.....16
 Teixeira, Erly.....24
 Truong, Truong.....21
 Tsigas, Marinos.....23

U

Uchida, Yoko..... 36, 41

ANNUAL CONFERENCE ON GLOBAL ECONOMIC ANALYSIS

V

Valdes, Constanza	20
van der Mensbrugghe, Dominique	14, 22, 43
Vanzetti, David	19, 35
Vielle, Marc.....	20

W

Walmsley, Terrie.....	19
Wang, Yue (Bonnie).....	16
Wettstein, Steen.....	34
Winchester, Niven	20, 31
Winning, Matthew	35
Wolf, Rayan.....	29

X

Xia, Yan.....	22
Xiao, Jingliang	21

Y

Yakut, Aykut Mert.....	24
Yang, Anton.....	35
Yu, Wusheng.....	20
Yuan, Wen.....	23

Z

Zanetti De Lima, Cicero	32
Zhang, Hainan	18
Zhang, Yaxiong	28

2019 CONFERENCE PREVIEW

22nd Annual Conference on Global Economic Analysis
“Challenges to global social and economic growth”



University of Warsaw
Warsaw, Poland | June 19-21, 2019

Objective

The objective of the annual conference on economic analysis is to promote the exchange of ideas among economists conducting quantitative analysis of global economic issues. Particular emphasis will be placed on applied general equilibrium methods, data, and application. Related theoretical and applied work is also welcome. This conference will focus around:

- International trade and trade policy and slowing down globalization
- Migrations, demographic change and the labor market
- Environmental challenges and energy policy

Important Dates/Deadlines

Abstract Submissions	November 2018 – January 15, 2019
Organized Session Proposal Submissions	November 2018 – January 15, 2019
Abstracts Review Period	mid-January – mid-February 2019
Status Notifications	early March 2019
Final Paper Submission	April 15, 2019
Early Registration	April 15, 2019
Late Registration	April 30, 2019
Registration Payment	May 7, 2019

Contact

Ginger Batta (gbatta@purdue.edu)
Senior Program Manager, Center for Global Trade Analysis
Department of Agricultural Economics, Purdue University

NOTES



Center for Global Trade Analysis

Department of Agricultural Economics, Purdue University
403 West State Street, West Lafayette, IN 47907-2056 USA
www.gtap.agecon.purdue.edu